

Madison, Wisconsin

CITY OF MADISON

CITY ENGINEERING DIVISION

DEPARTMENT OF PUBLIC WORKS

PLAN OF PROPOSED IMPROVEMENT

PUBLIC IMPROVEMENT PROJECT APPROVED

FEBRUARY 5, 2019

BY THE COMMON COUNCIL
OF MADISON, WISCONSIN

PUBLIC IMPROVEMENT DESIGN
APPROVED BY:

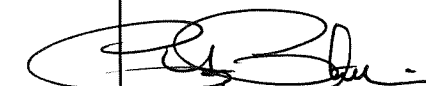
 2/21/19
City Engineer Date

STREET
DESIGNED BY:

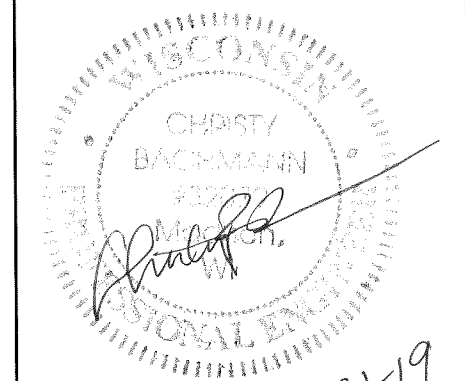
2-21-19

SANITARY SEWER
DESIGNED BY:

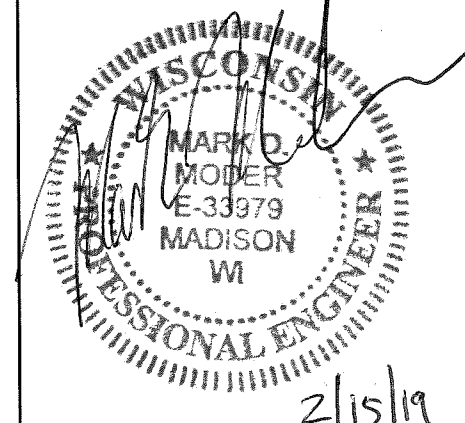
2/15/19

STORM SEWER
DESIGNED BY:

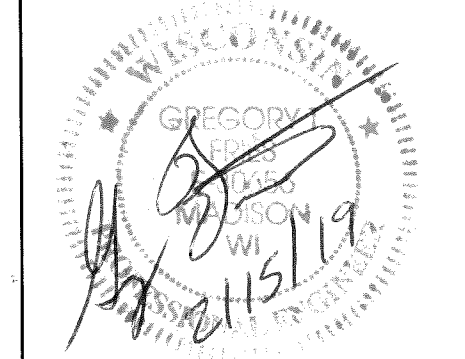

2/15/19

GROVELAND TERRACE ASSESSMENT DISTRICT - 2019

CITY MUNIS NO. 11872
CONTRACT NO. 8298

INDEX OF SHEETS

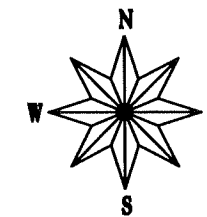
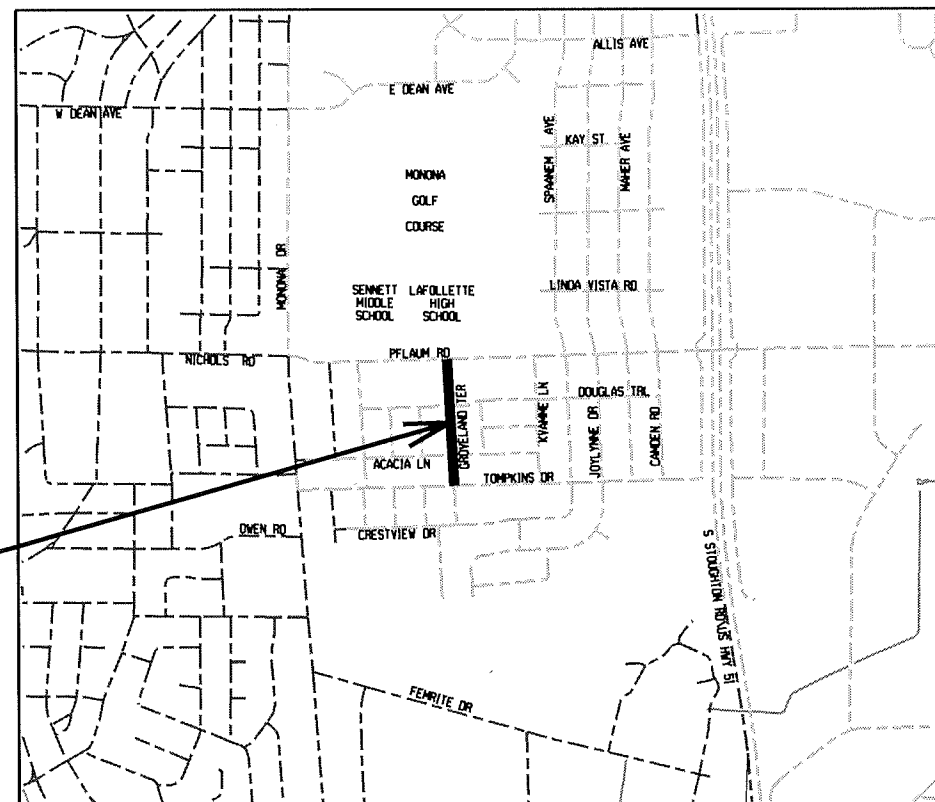
SHEET NO.	TITLE
1	TYPICAL SECTIONS AND DETAILS
D1	SIDEWALK DETAILS
D2	EROSION CONTROL PLANS
EC1-EC3	GROVELAND TERRACE PLAN & PROFILE
PI-P3	RAIN GARDEN DETAIL
RG-1	GROVELAND TERRACE UTILITIES PLAN & PROFILE
UI-U3	SANITARY SEWER SCHEDULE
U4	STORM SEWER SCHEDULES
U5	CROSS SECTIONS GROVELAND TERRACE
XI-X9	



PROJECT
LOCATION

CONVENTIONAL SIGNS	
FIELD VERIFY ALL UTILITY LOCATIONS	
GAS	— G —
STORM SEWER	— ST —
SANITARY SEWER	— SAN —
WATER	— W —
OVERHEAD ELECTRIC	— OH —
POWER POLE	□

NOTES:

ALL GUTTERS SHALL DRAIN WITH A MINIMUM GRADE OF 0.50% TOWARD STORM SEWER INLETS.

SIDEWALK RAMPS AND CURB THRU SIDEWALK RAMPS SHALL HAVE A MAXIMUM SLOPE OF 1" PER 12". SIDEWALK AND CURB RAMPS SHALL BE CONSTRUCTED WITH A SIDE SLOPE OF 1.50%. SIDEWALK SHALL HAVE A MINIMUM LONGITUDINAL SLOPE OF 0.50% AND A MAXIMUM LONGITUDINAL SLOPE OF 5.00%

EARTH WORK SUMMARY:
EXCAVATION CUT (MEASURED PLAN QUANTITY).....2400 C.Y.
ESTIMATED UNDISTRIBUTED UNDERCUT..... 480 C.Y.
TOTAL UNCLASSIFIED EXCAVATION CUT.....2880 C.Y.

PLOT SCALE: _____

PLOT NAME: _____

REV. DATE: _____

ORIGINATOR: CITY OF MADISON, STREETS DIVISION

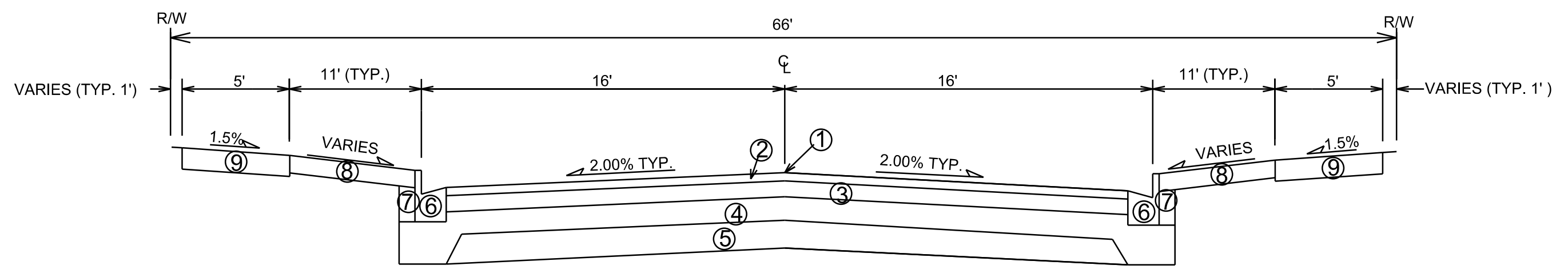

- ① POINT REFERRED TO ON PROFILE
- ② 1.75" BITUMINOUS UPPER LAYER (4 LT 58-28 S)
- ③ 1.75" BITUMINOUS LOWER LAYER (4 LT 58-28 S)
- ④ 6" GRADATION 2 CRUSHED STONE
- ⑤ 6" GRADATION 1 CRUSHED STONE
- ⑥ TYPE 'A' CONCRETE CURB & GUTTER
- ⑦ FILL, INCIDENTAL
- ⑧ 6" TOPSOIL, SEED & MAT
- ⑨ 5" CONCRETE SIDEWALK

TYPICAL FINISHED SECTION
GROVELAND TERRACE

TYPICAL SECTIONS NOT TO SCALE

SEE CROSS SECTION SHEETS FOR CROSS
SLOPES, TOP OF CURB AND BACK OF WALK ELEVATIONS.

PLOT SCALE: _____
PLOT NAME: _____
REV. DATE: _____
ORIGINATOR: CITY OF MADISON, STREETS DIVISION

SIDEWALK DETAILS

GROVELAND TERRACE CITY OF MADISON

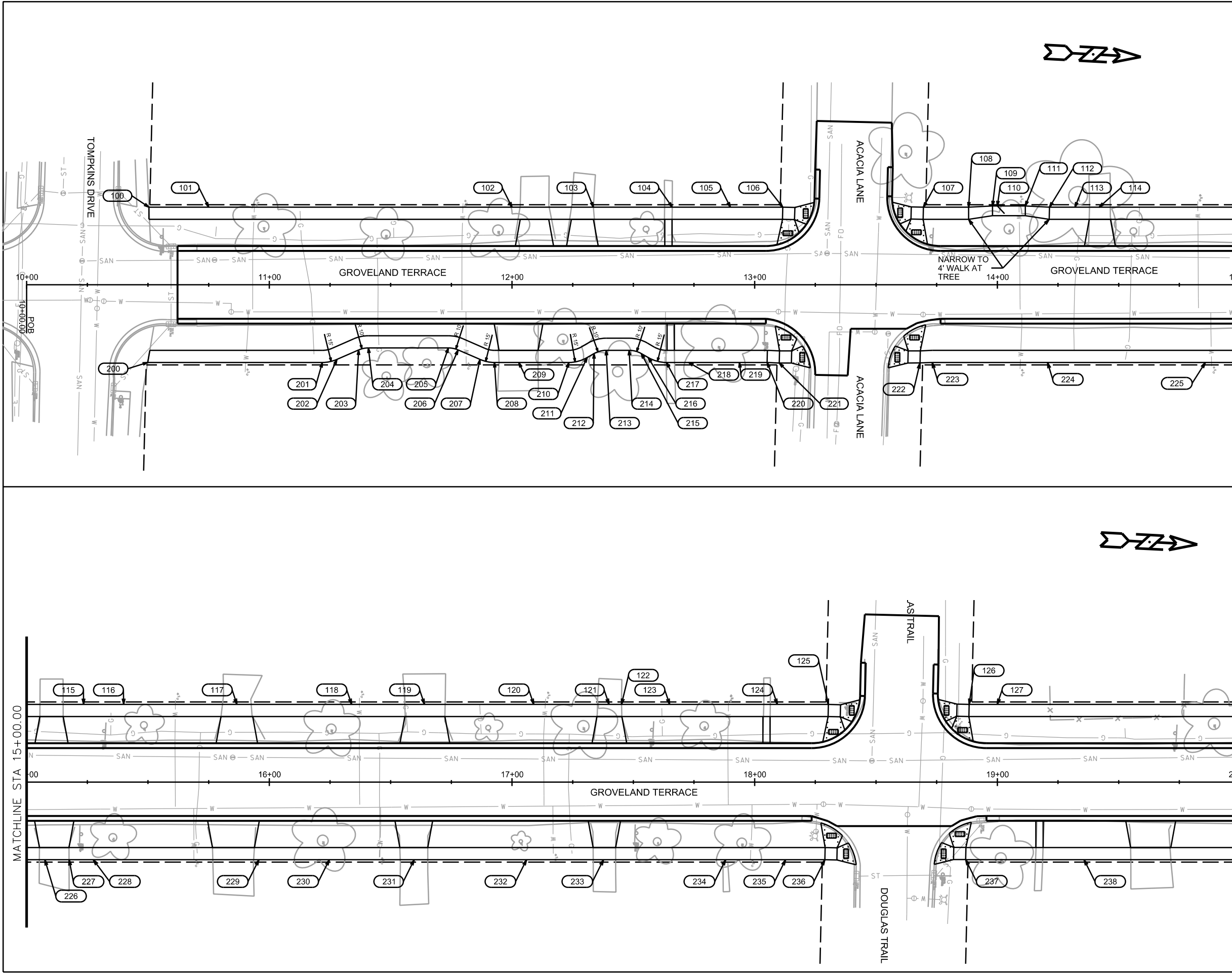

POINT	STATION	OFFSET	ELEV.	DESCRIPTION
100	10+50.38	32.00' LT	906.92	BW/MATCH EX.
101	10+75.00	32.00' LT	906.31	BW/GRADE BRK.
102	12+00.00	32.00' LT	905.68	BW/GRADE BRK.
103	12+33.52	32.00' LT	905.36	BW/LO POINT
104	12+66.04	32.00' LT	905.53	BW/PI POINT
105	12+90.00	32.00' LT	905.32	BW/GRADE BRK.
106	13+11.55	32.00' LT	904.24	BW/KEYSTONE
107	13+69.51	32.00' LT	904.42	BW/KEYSTONE
108	13+88.15	32.00' LT	905.29	BW/PI
109	13+98.04	32.50' LT	905.75	BW/PI
110	13+99.99	32.50' LT	905.84	BW/GRADE BRK.
111	14+11.52	32.50' LT	906.02	BW/PI
112	14+21.51	32.00' LT	906.18	BW/PI
113	14+31.97	32.00' LT	906.34	BW/PI POINT
114	14+41.97	32.00' LT	906.24	BW/LO POINT
115	15+23.46	32.00' LT	907.09	BW/GRADE BRK.
116	15+39.97	32.00' LT	907.92	BW/PI POINT
117	15+86.65	32.00' LT	907.68	BW/LO POINT
118	16+33.93	32.00' LT	908.66	BW/PI POINT
119	16+63.93	32.00' LT	908.51	BW/LO POINT
120	17+08.97	32.00' LT	909.00	BW/PI POINT
121	17+39.97	32.00' LT	908.73	BW/LO POINT
122	17+45.11	32.00' LT	908.75	BW/GRADE BRK.
123	17+64.97	32.00' LT	909.18	BW/GRADE BRK.
124	18+09.33	32.00' LT	909.40	BW/PI POINT
125	18+30.38	32.00' LT	908.35	BW/KEYSTONE
126	18+88.40	32.00' LT	908.69	BW/KEYSTONE
127	18+99.97	32.00' LT	908.96	BW/GRADE BRK.
200	10+49.90	32.00' RT	906.47	BW/MATCH EX.
201	11+21.87	32.00' RT	906.00	BW/PC
202	11+27.87	30.75' RT	905.96	BW/PC
203	11+36.83	26.83' RT	905.89	BW/PC
204	11+40.83	26.00' RT	905.86	BW/PC
205	11+73.79	26.00' RT	905.65	BW/PC/GRADE BRK.
206	11+77.77	26.83' RT	905.57	BW/PC
207	11+86.80	30.76' RT	905.38	BW/PC
208	11+92.78	32.00' RT	905.27	BW/PC
209	12+02.79	32.00' RT	905.08	BW/LO POINT
210	12+23.46	32.00' RT	905.18	BW/PC
211	12+30.96	29.99' RT	905.22	BW/PC
212	12+33.82	28.34' RT	905.24	BW/PC
213	12+38.82	27.00' RT	905.26	BW/PC
214	12+48.28	27.00' RT	905.31	BW/PC
215	12+53.28	28.34' RT	905.34	BW/PC
216	12+56.14	29.99' RT	905.35	BW/PC
217	12+63.64	32.00' RT	905.39	BW/PC
218	12+72.73	32.00' RT	905.44	BW/PI POINT
219	12+93.73	32.00' RT	905.13	BW/GRADE BRK.
220	13+05.13	32.00' RT	904.56	BW/PI
221	13+10.12	32.25' RT	904.31	BW/PI/KEYSTONE
222	13+68.14	32.22' RT	904.44	BW/PI/KEYSTONE
223	13+73.14	32.00' RT	904.56	BW/PI
224	14+20.72	32.00' RT	905.65	BW/GRADE BRK.
225	14+85.72	32.00' RT	906.23	BW/PI POINT
226	15+07.47	32.00' RT	906.09	BW/LO POINT
227	15+17.47	32.00' RT	906.23	BW/GRADE BRK.
228	15+27.47	32.00' RT	906.73	BW/GRADE BRK.
229	15+95.72	32.00' RT	907.27	BW/GRADE BRK.
230	16.24.72	32.00' RT	908.09	BW/PI POINT
231	16+59.72	32.00' RT	907.86	BW/LO POINT
232	17+06.00	32.00' RT	908.83	BW/PI POINT
233	17+37.72	32.00' RT	908.38	BW/LO POINT
234	17+88.02	32.00' RT	909.14	BW/PI POINT
235	18+12.72	32.00' RT	909.01	BW/GRADE BRK.
236	18+28.90	32.00' RT	908.20	BW/KEYSTONE
237	18+86.92	32.00' RT	908.71	BW/KEYSTONE
238	19+35.72	32.00' RT	909.23	BW/GRADE BRK.

PLOT SCALE: _____

PLOT NAME: _____

REV. DATE: _____

ORIGINATOR: CITY OF MADISON, STREETS DIVISION

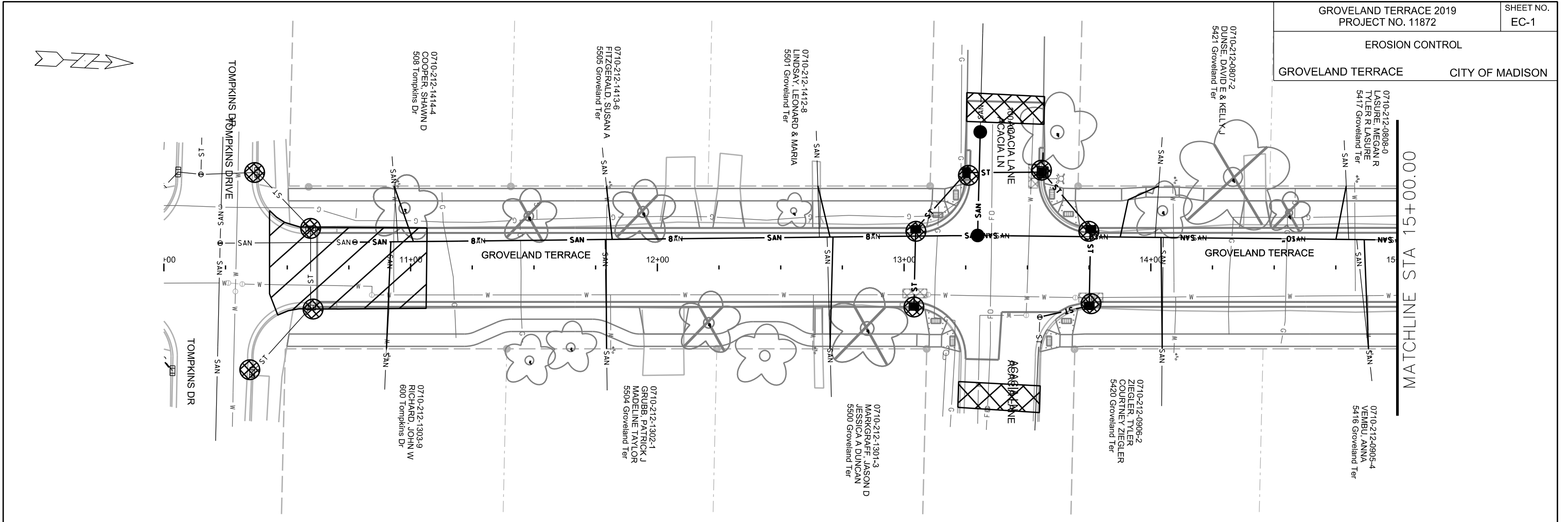

	STREET CONSTRUCTION ENTRANCE BERM
	CONSTRUCTION ENTRANCE
	TYPE D HYBRID INLET PROTECTION
	TYPE C INLET PROTECTION
	SILT SOCK (VELOCITY CHECK)
	STREET CONSTRUCTION STONE BERM

EROSION CONTROL NOTES:
EROSION CONTROL MEASURES SHALL BE IN PLACE PRIOR TO ANY OTHER CONSTRUCTION ACTIVITY.

THE CONTRACTOR IS RESPONSIBLE FOR THE CONSTRUCTION AND MAINTENANCE OF ALL EROSION CONTROL MEASURES UNTIL FINAL ACCEPTANCE BY THE CITY OF MADISON.

THE CONTRACTOR SHALL INSTALL AND MAINTAIN EROSION CONTROL MEASURES IN ACCORDANCE WITH THE WDNR SOC STANDARDS AND CITY OF MADISON STANDARD SPECIFICATIONS.

THE CONTRACTOR SHALL PROVIDE STREET CLEANING AS NEEDED ON A DAILY BASIS TO KEEP TRACKING TO A MINIMUM.

INLET PROTECTION SHALL BE INSTALLED WITHIN THE CONSTRUCTION LIMITS. ADDITIONAL INLET PROTECTION SHALL BE INSTALLED AS DIRECTED.

POLYMER SHALL BE APPLIED TO DISTURBED AREAS AS DIRECTED BY THE CONSTRUCTION ENGINEER.

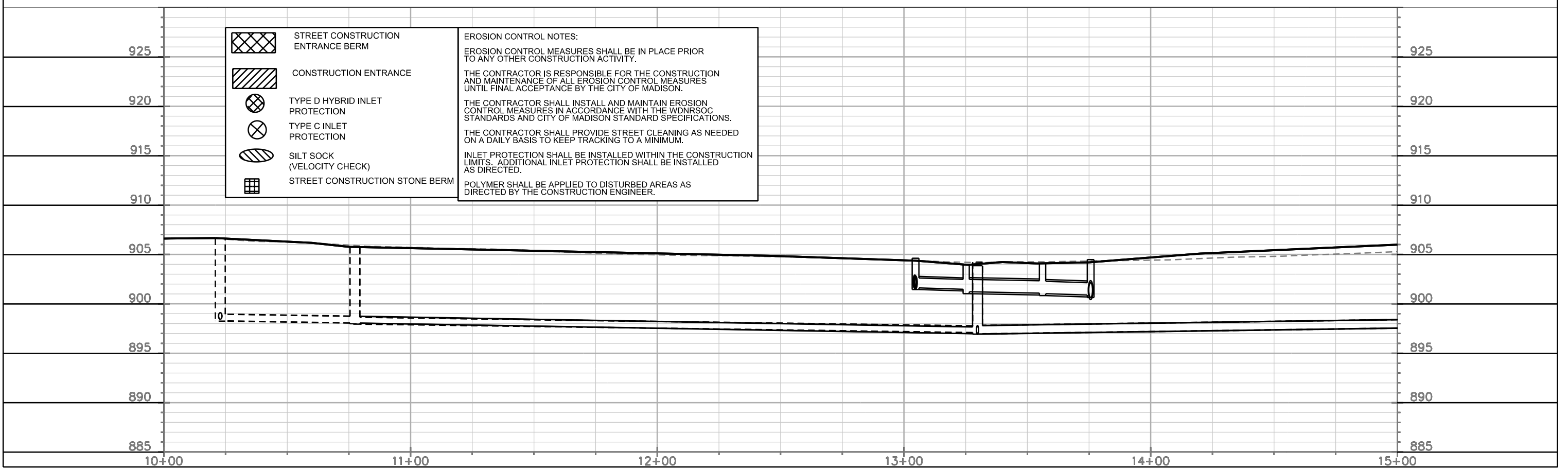

PLOT SCALE:

PLOT NAME:

REV. DATE:

ORIGINATOR: CITY OF MADISON, STREETS DIVISION

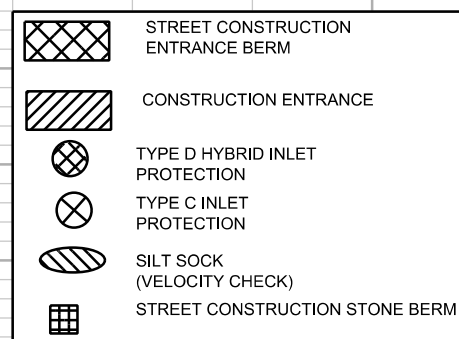
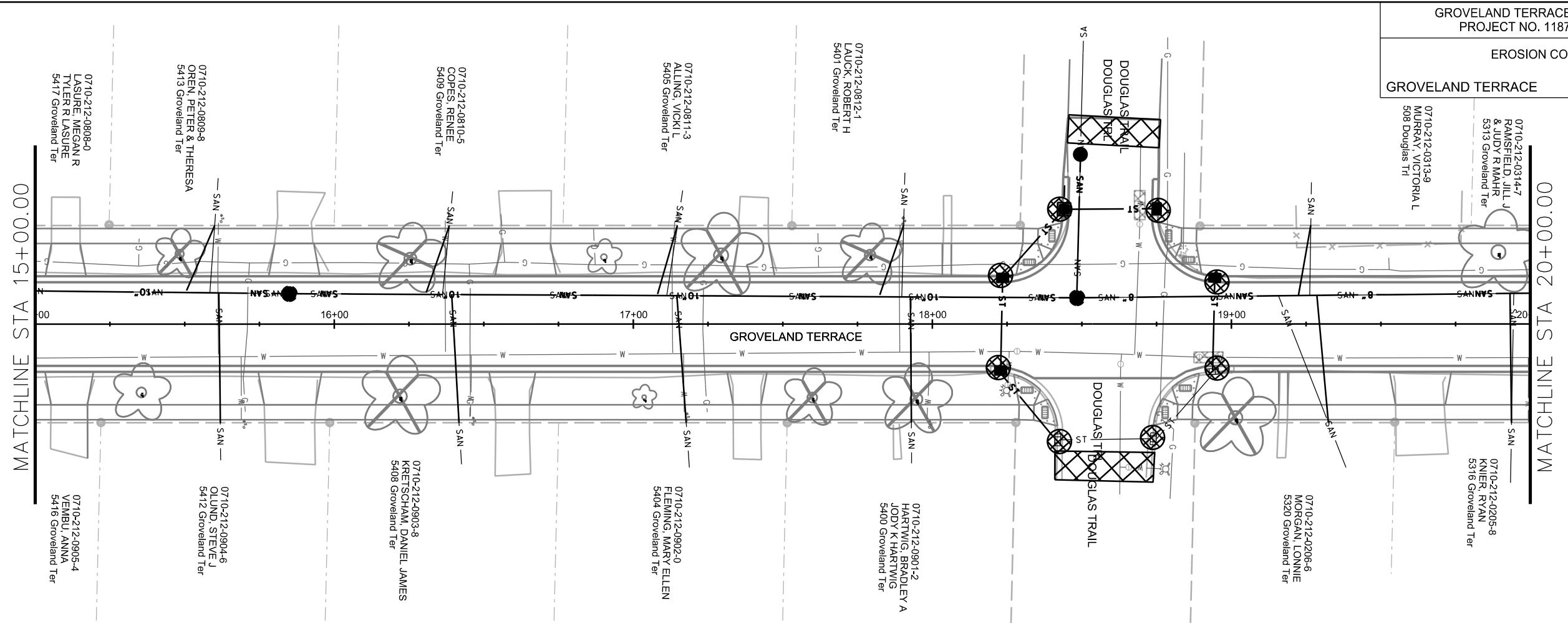

EROSION CONTROL NOTES:

EROSION CONTROL MEASURES SHALL BE IN PLACE PRIOR TO ANY OTHER CONSTRUCTION ACTIVITY.

THE CONTRACTOR IS RESPONSIBLE FOR THE CONSTRUCTION AND MAINTENANCE OF ALL EROSION CONTROL MEASURES UNTIL FINAL ACCEPTANCE BY THE CITY OF MADISON.

THE CONTRACTOR SHALL INSTALL AND MAINTAIN EROSION CONTROL MEASURES IN ACCORDANCE WITH THE WDNR SOC STANDARDS AND CITY OF MADISON STANDARD SPECIFICATIONS.

THE CONTRACTOR SHALL PROVIDE STREET CLEANING AS NEEDED ON A DAILY BASIS TO KEEP TRACKING TO A MINIMUM.

INLET PROTECTION SHALL BE INSTALLED WITHIN THE CONSTRUCTION LIMITS. ADDITIONAL INLET PROTECTION SHALL BE INSTALLED AS DIRECTED.

POLYMER SHALL BE APPLIED TO DISTURBED AREAS AS DIRECTED BY THE CONSTRUCTION ENGINEER.

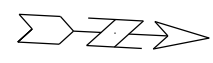
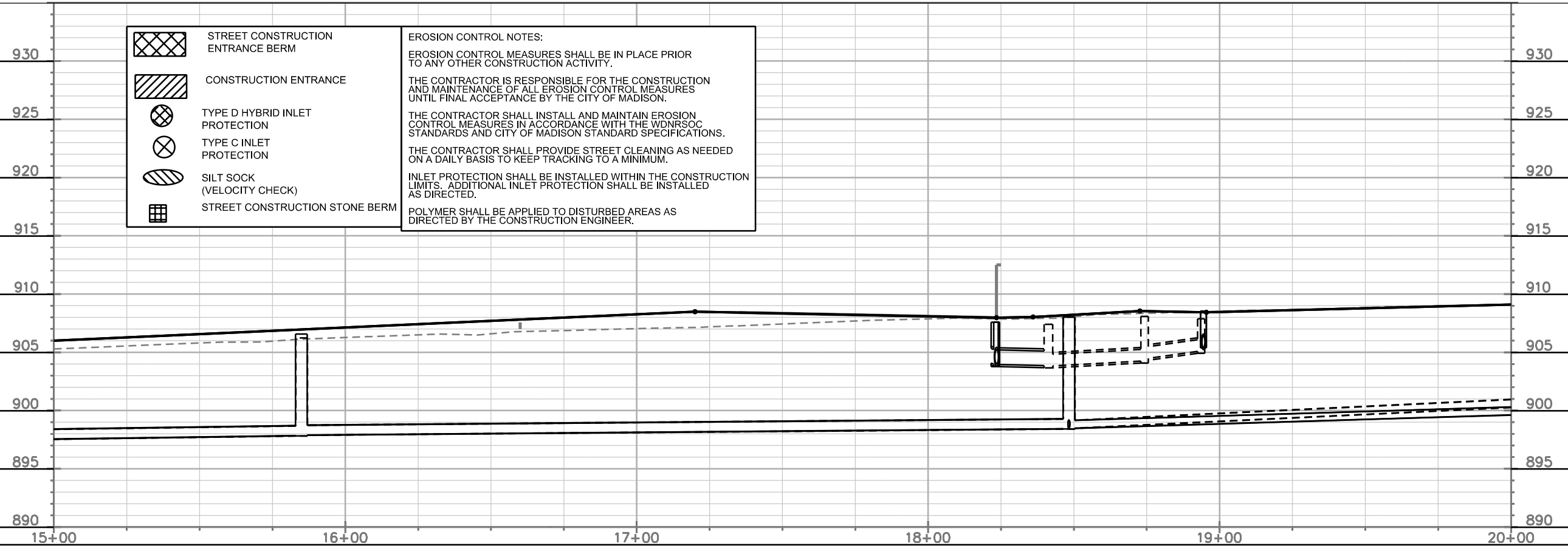

PLOT SCALE: _____

PLOT NAME: _____

REV. DATE: _____

ORIGINATOR: CITY OF MADISON, STREETS DIVISION

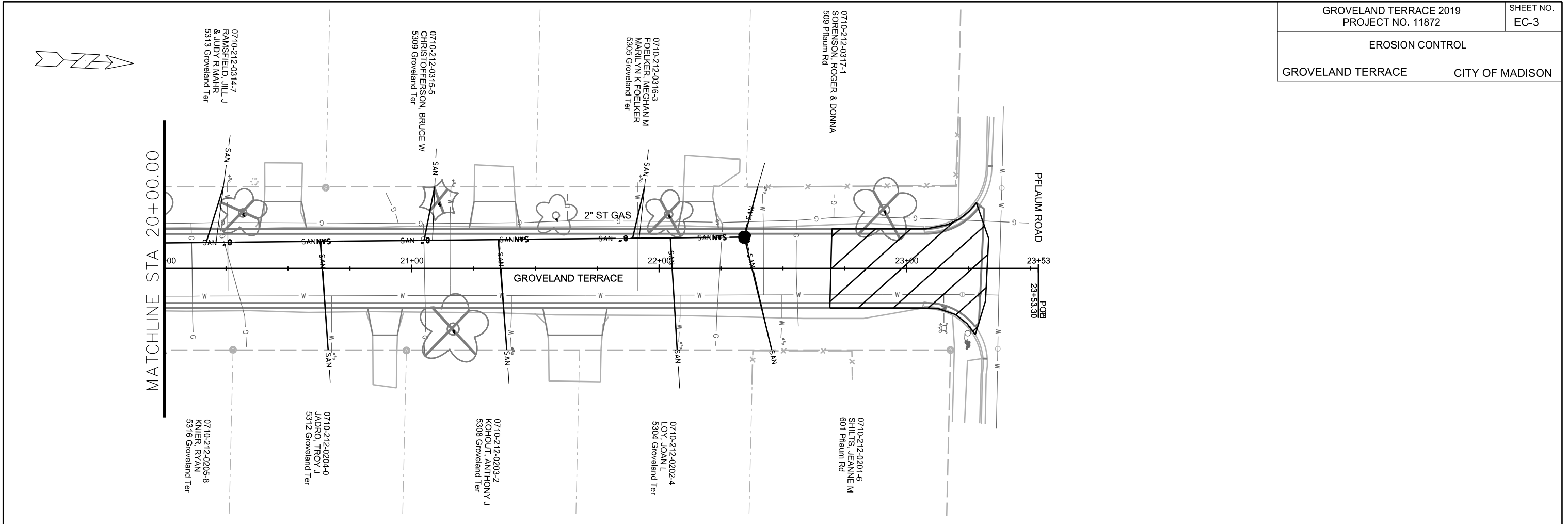

MATCHLINE STA 20+00.00

PFLAUM ROAD
23+53
POB
23+53.30

0710-212-0314-7
RAMSFIELD, JILL J
& JUDY R MAHR
5313 Groveland Ter

0710-212-0315-5
CHRISTOFFERSON, BRUCE W
5309 Groveland Ter

0710-212-0316-3
FOELKER, MEGHAN M
MARILYN K FOELKER
5305 Groveland Ter

0710-212-0317-1
SORENSEN, ROGER & DONNA
509 Pflaum Rd





0710-212-0205-8
KNIER, RYAN
5316 Groveland Ter

0710-212-0204-0
JADRO, TROY J
5312 Groveland Ter

0710-212-0203-2
KOHOUT, ANTHONY J
5308 Groveland Ter

0710-212-0202-4
LOY, JOAN L
5304 Groveland Ter

0710-212-0201-6
SHILTS, JEANNE M
601 Pflaum Rd

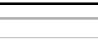
-  STREET CONSTRUCTION ENTRANCE BERM
-  CONSTRUCTION ENTRANCE
-  TYPE D HYBRID INLET PROTECTION
-  TYPE C INLET PROTECTION
-  SILT SOCK (VELOCITY CHECK)
-  STREET CONSTRUCTION STONE BERM

EROSION CONTROL NOTES:
EROSION CONTROL MEASURES SHALL BE IN PLACE PRIOR TO ANY OTHER CONSTRUCTION ACTIVITY.

THE CONTRACTOR IS RESPONSIBLE FOR THE CONSTRUCTION AND MAINTENANCE OF ALL EROSION CONTROL MEASURES UNTIL FINAL ACCEPTANCE BY THE CITY OF MADISON.

THE CONTRACTOR SHALL INSTALL AND MAINTAIN EROSION CONTROL MEASURES IN ACCORDANCE WITH THE WDNR SOC STANDARDS AND CITY OF MADISON STANDARD SPECIFICATIONS.

THE CONTRACTOR SHALL PROVIDE STREET CLEANING AS NEEDED ON A DAILY BASIS TO KEEP TRACKING TO A MINIMUM.

INLET PROTECTION SHALL BE INSTALLED WITHIN THE CONSTRUCTION LIMITS. ADDITIONAL INLET PROTECTION SHALL BE INSTALLED AS DIRECTED.

POLYMER SHALL BE APPLIED TO DISTURBED AREAS AS DIRECTED BY THE CONSTRUCTION ENGINEER.

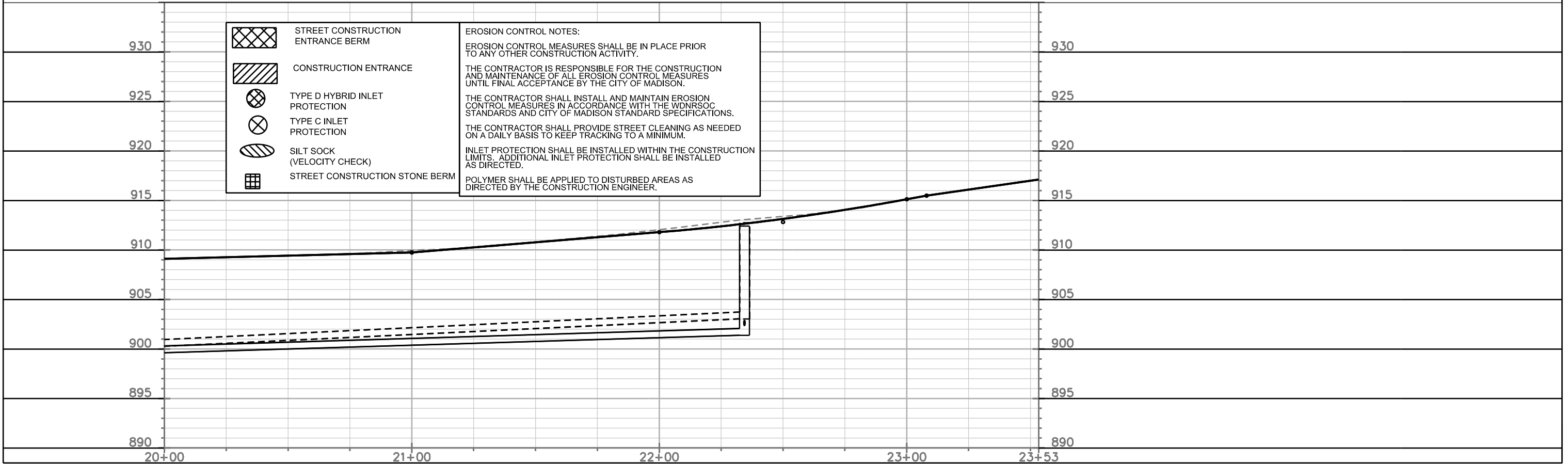

PLOT SCALE:

PLOT NAME:

REV. DATE:

ORIGINATOR: CITY OF MADISON, STREETS DIVISION

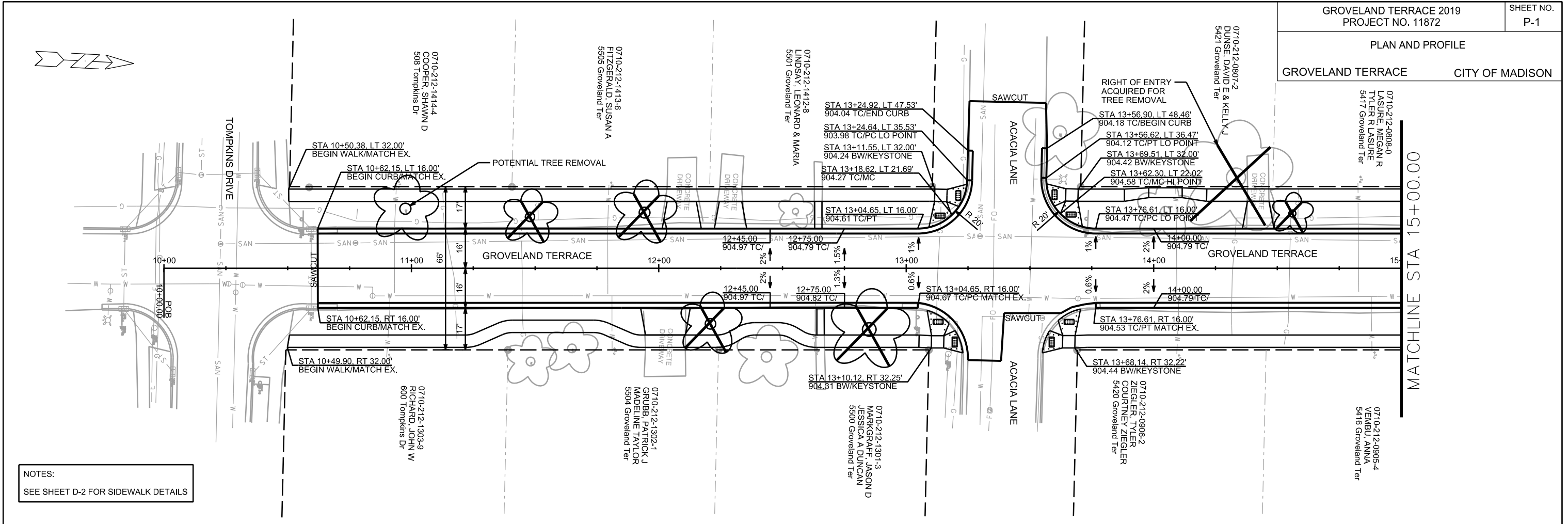

NOTES:
SEE SHEET D-2 FOR SIDEWALK DETAILS

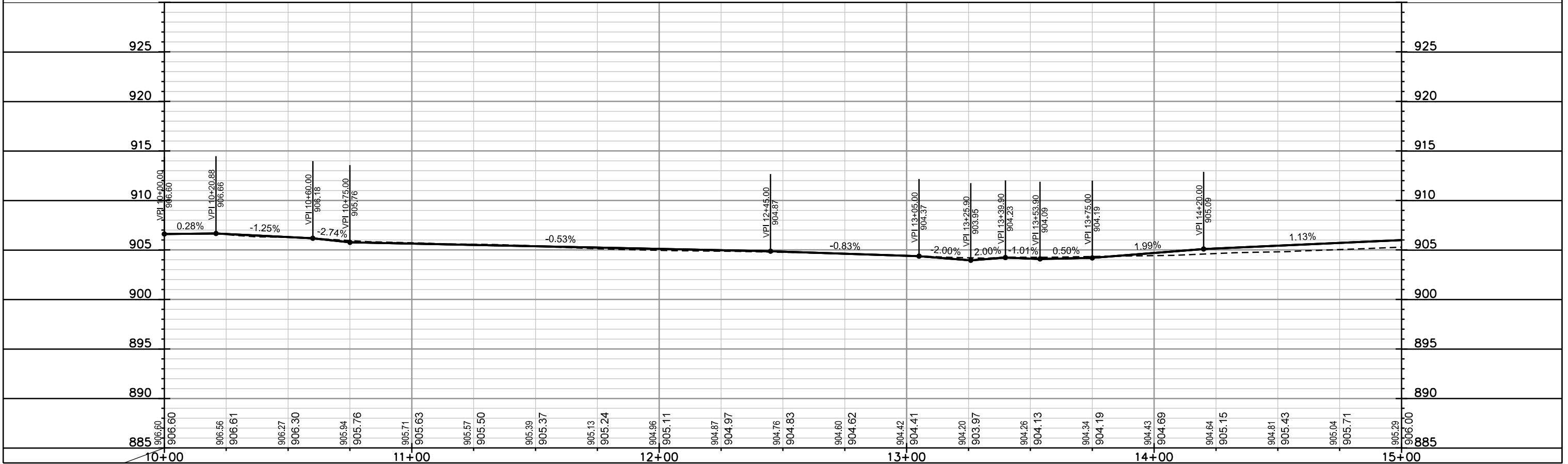

PLOT SCALE:

PLOT NAME:

REV. DATE:

ORIGINATOR: CITY OF MADISON, STREETS DIVISION

PLAN AND PROFILE
GROVELAND TERRACE CITY OF MADISON

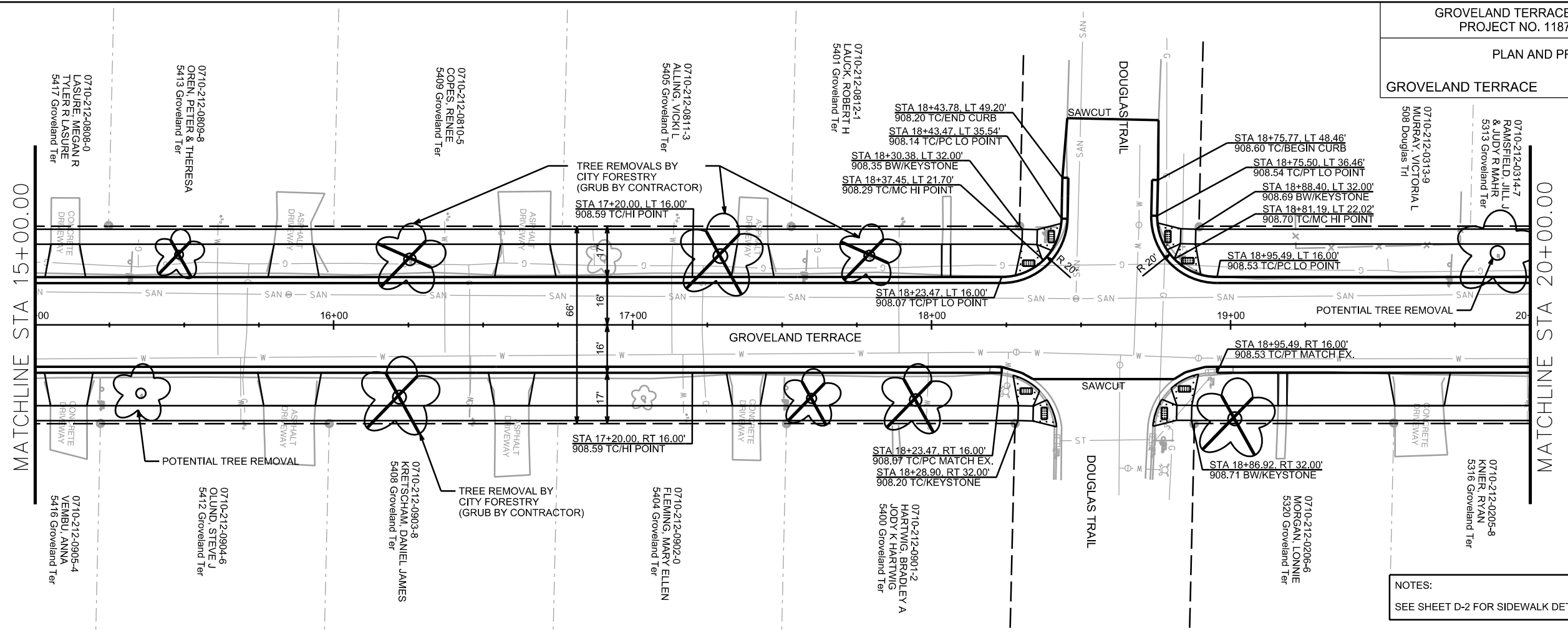

NOTES:
SEE SHEET D-2 FOR SIDEWALK DETAILS

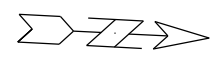
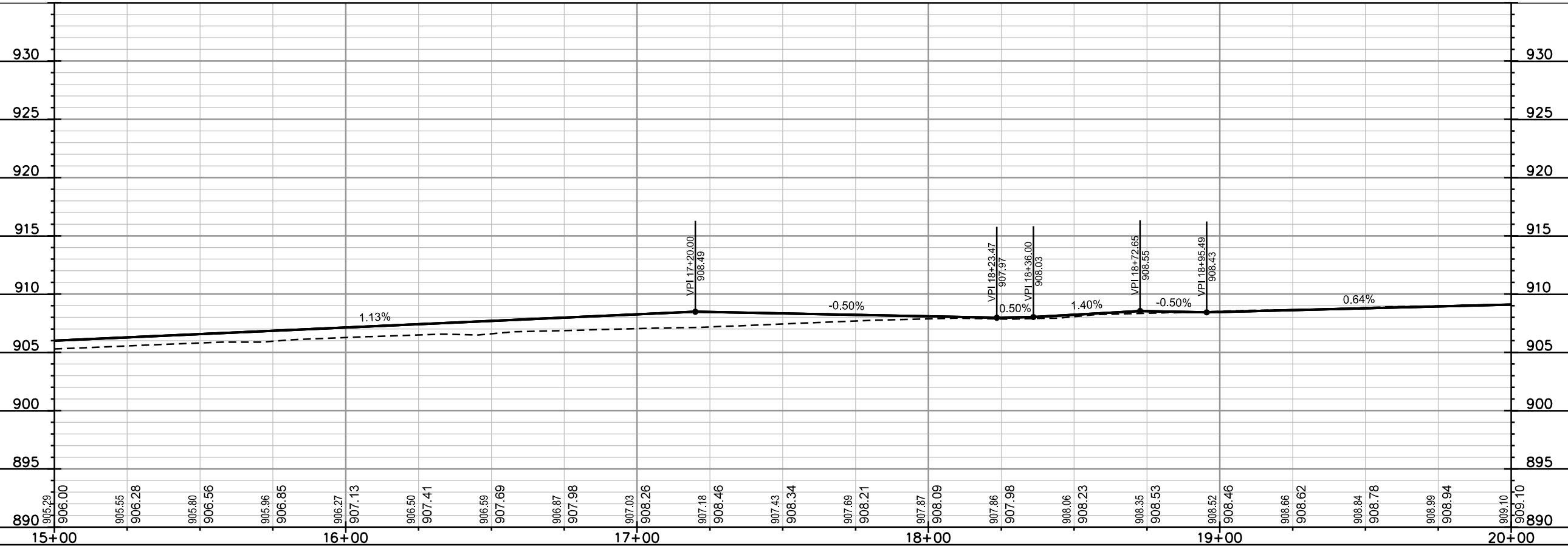

PLOT SCALE: _____

PLOT NAME: _____

REV. DATE: _____

ORIGINATOR: CITY OF MADISON, STREETS DIVISION

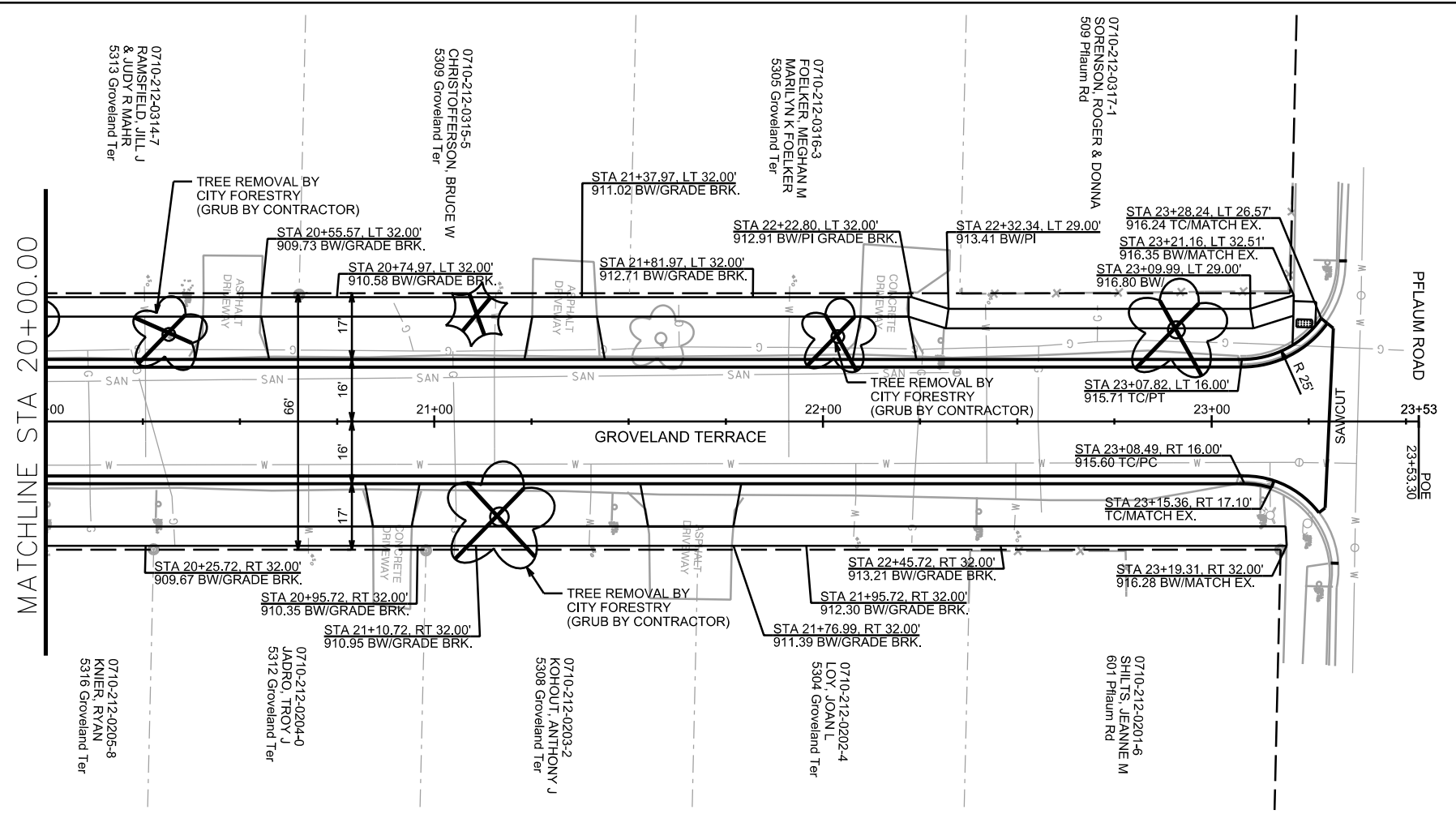
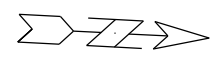

PLOT NAME: _____

REV. DATE: _____

ORIGINATOR: CITY OF MADISON, STREETS DIVISION

RAIN GARDEN PLAN

5409 Groveland Terrace CITY OF MADISON

0710-212-0810-5
COPEL, RENEE
5409 Groveland Ter

0710-2
KRETS
5408 G

STA 16+17.91, LT 26.00'
908.15 @ POINT

STA 16+12.70, LT 20.78'
906.41 @ BOTTOM

STA 16+06.96, LT 21.95'
906.41 @ BOTTOM

STA 16+02.91, LT 26.00'
907.76 @ POINT

STA 16+17.91, LT 17.50'
907.51 @ POINT

STA 16+15.21, LT 20.20'
906.41 @ BOTTOM

STA 16+11.18, LT 16.54'
906.68 @ CURB EDGE

STA 16+11.16, LT 18.55'
906.53 @ BOTTOM OF FLUME

STA 16+05.61, LT 20.20'
906.41 @ BOTTOM

STA 16+02.91, LT 17.50'
907.31 @ POINT

NOTE: ENGINEERING SOIL MIX BOUNDARY IS 55 SQUARE FEET
NOTE: ENGINEERING SOIL MIX SHALL BE INSTALLED TO A DEPTH OF 2 FEET AND CONSIST OF THE SAND AND COMPOST MIX SPECIFIED IN ARTICLE 211.2(a) OF THE CITY STANDARD SPECIFICATIONS

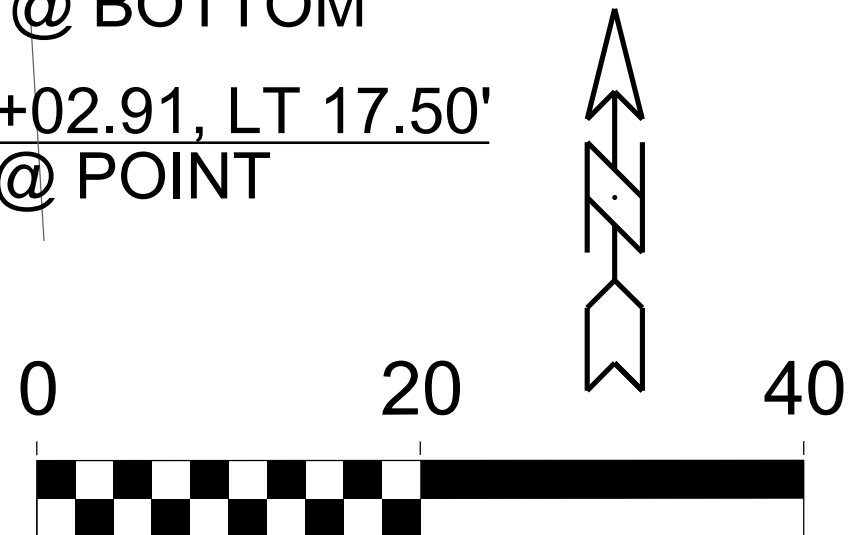

PLOT SCALE: 20

PLOT NAME: RG-1

REV. DATE:

ORIGINATOR: CITY OF MADISON, STREETS DIVISION

SEWER
PLAN AND PROFILE

GROVELAND TERRACE CITY OF MADISON

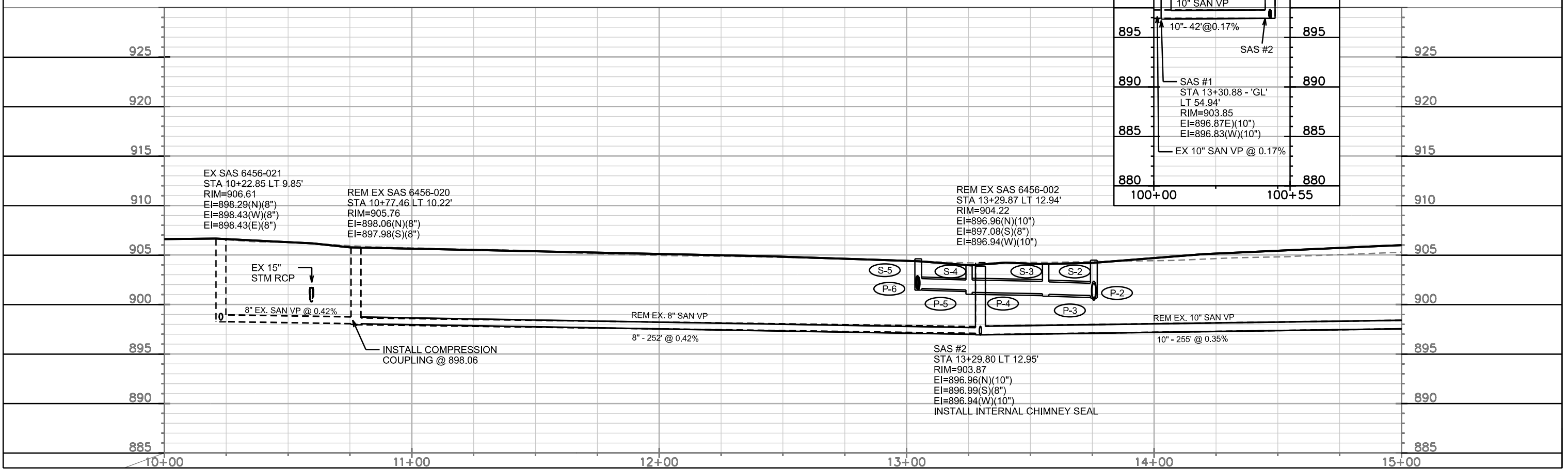
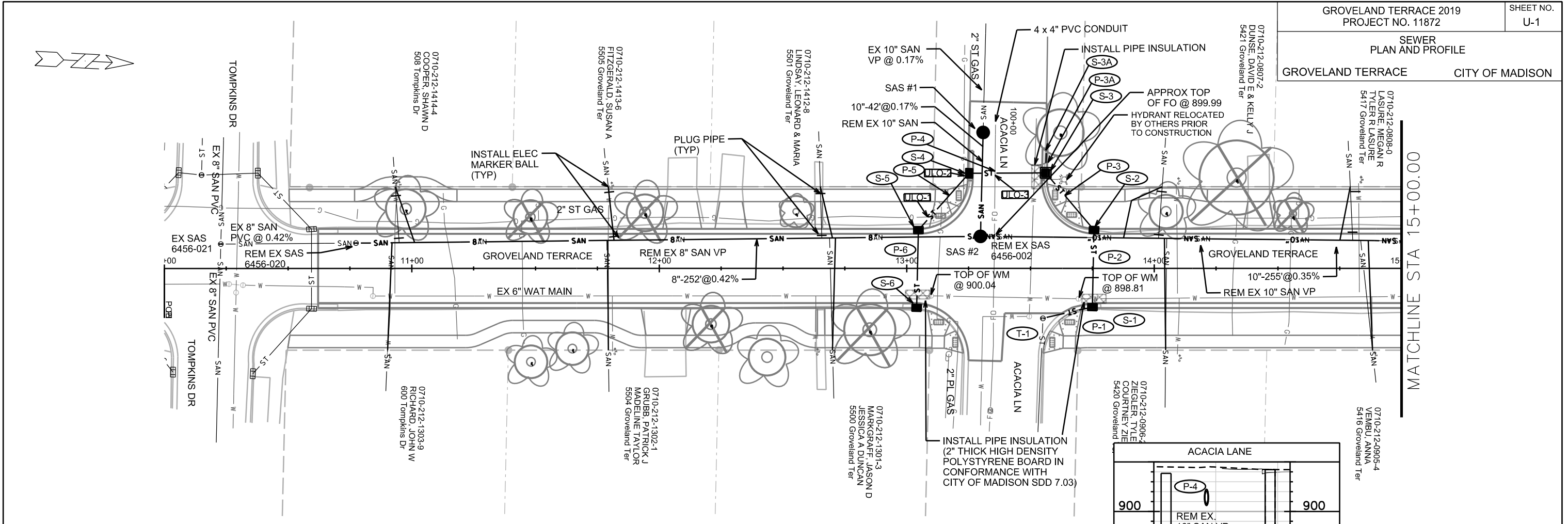

SEWER
PLAN AND PROFILE
GROVELAND TERRACE CITY OF MADISON

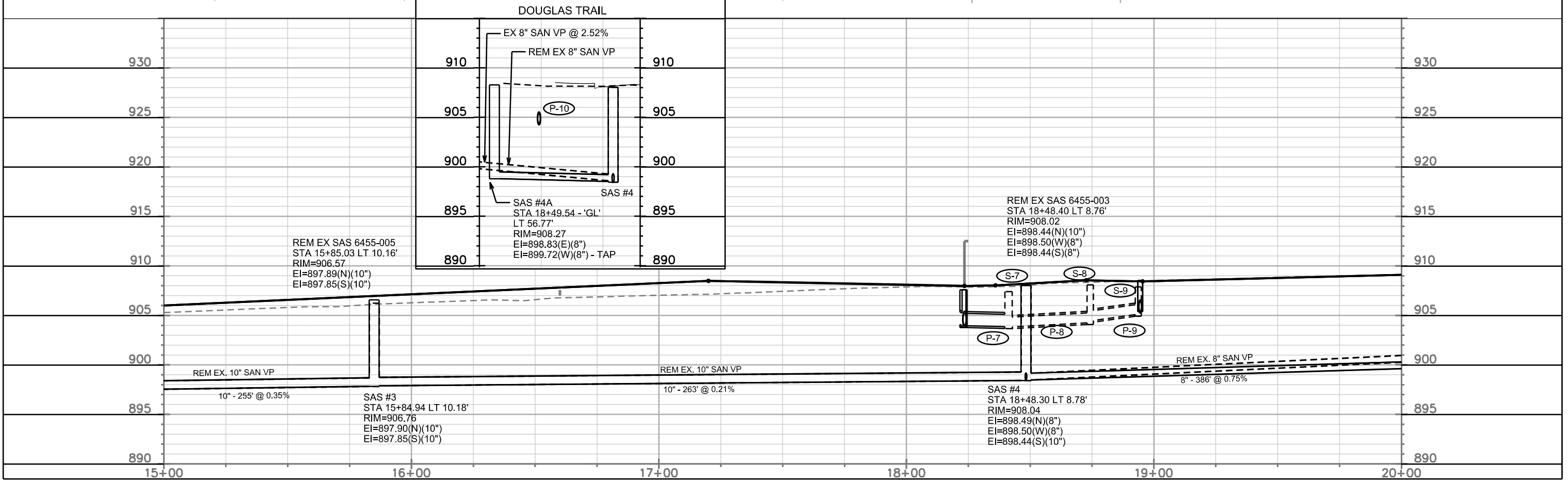
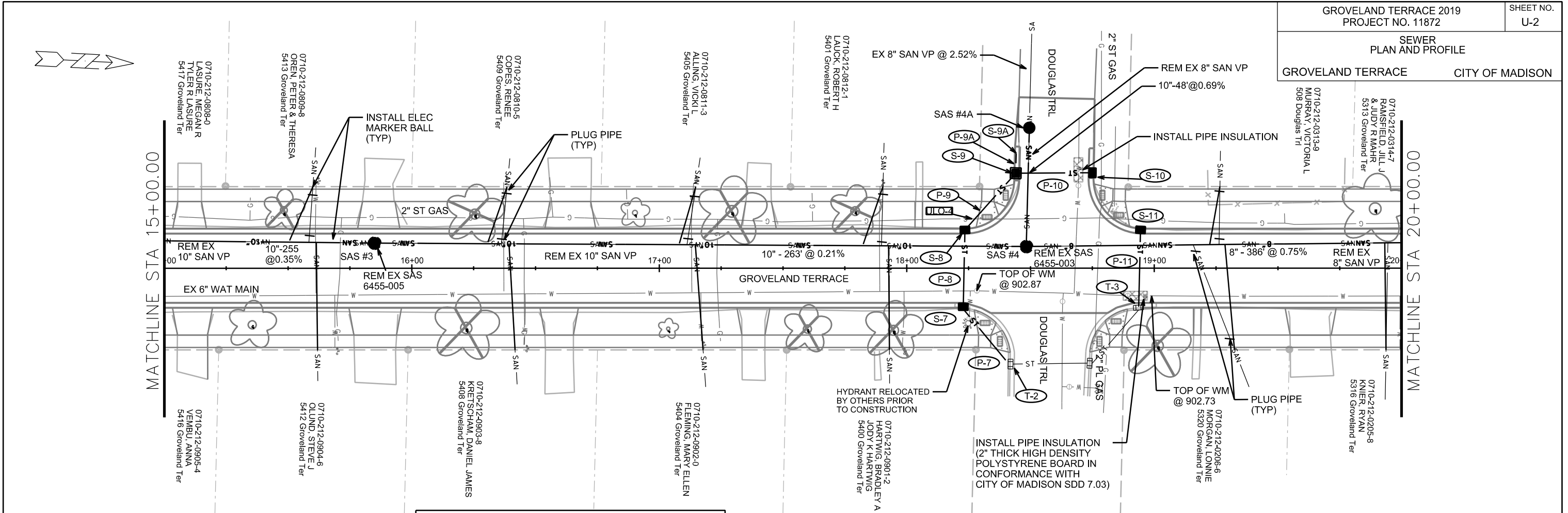

PLOT SCALE:

PLOT NAME:

REV. DATE:

ORIGINATOR: CITY OF MADISON, STREETS DIVISION

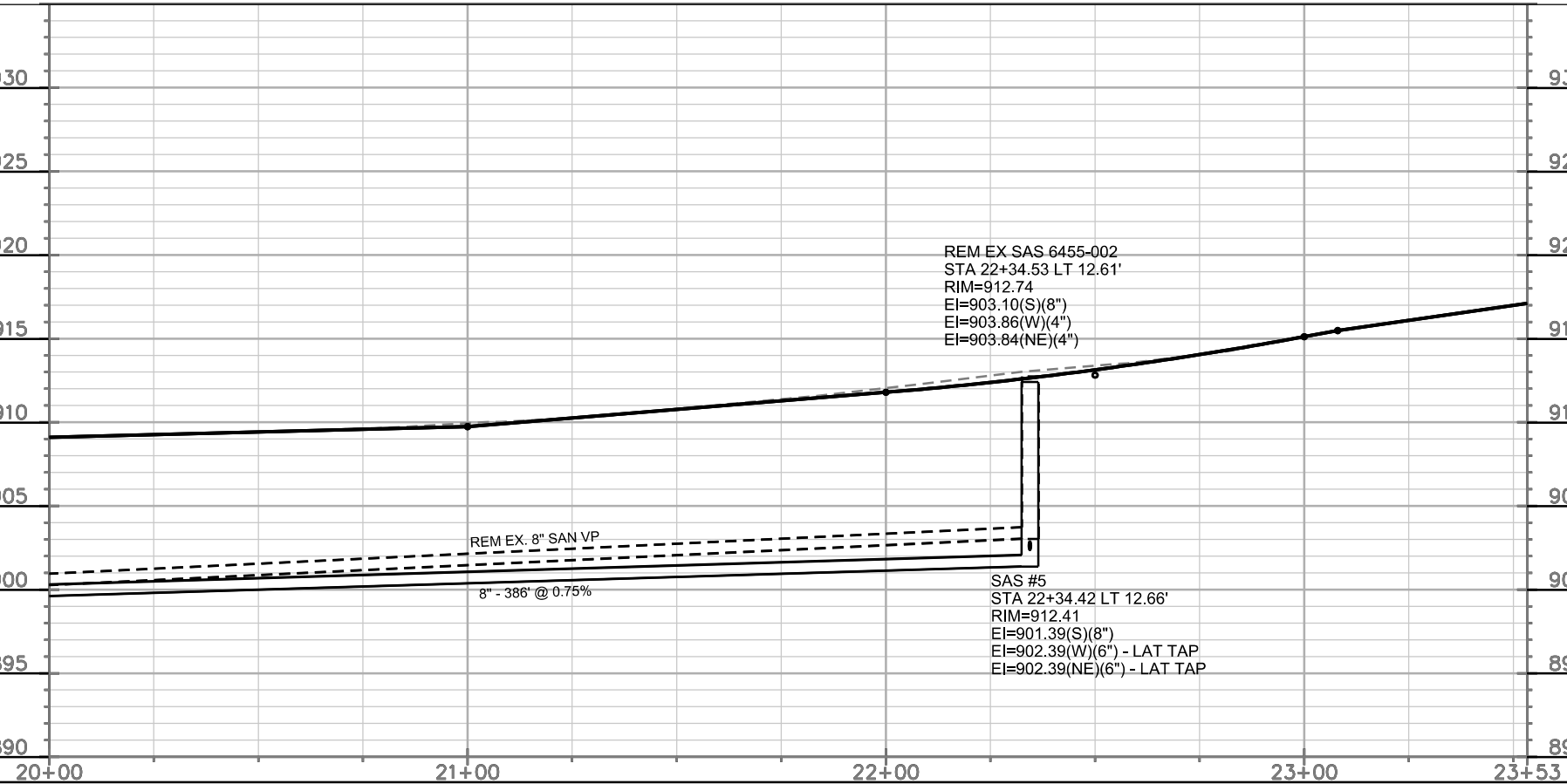
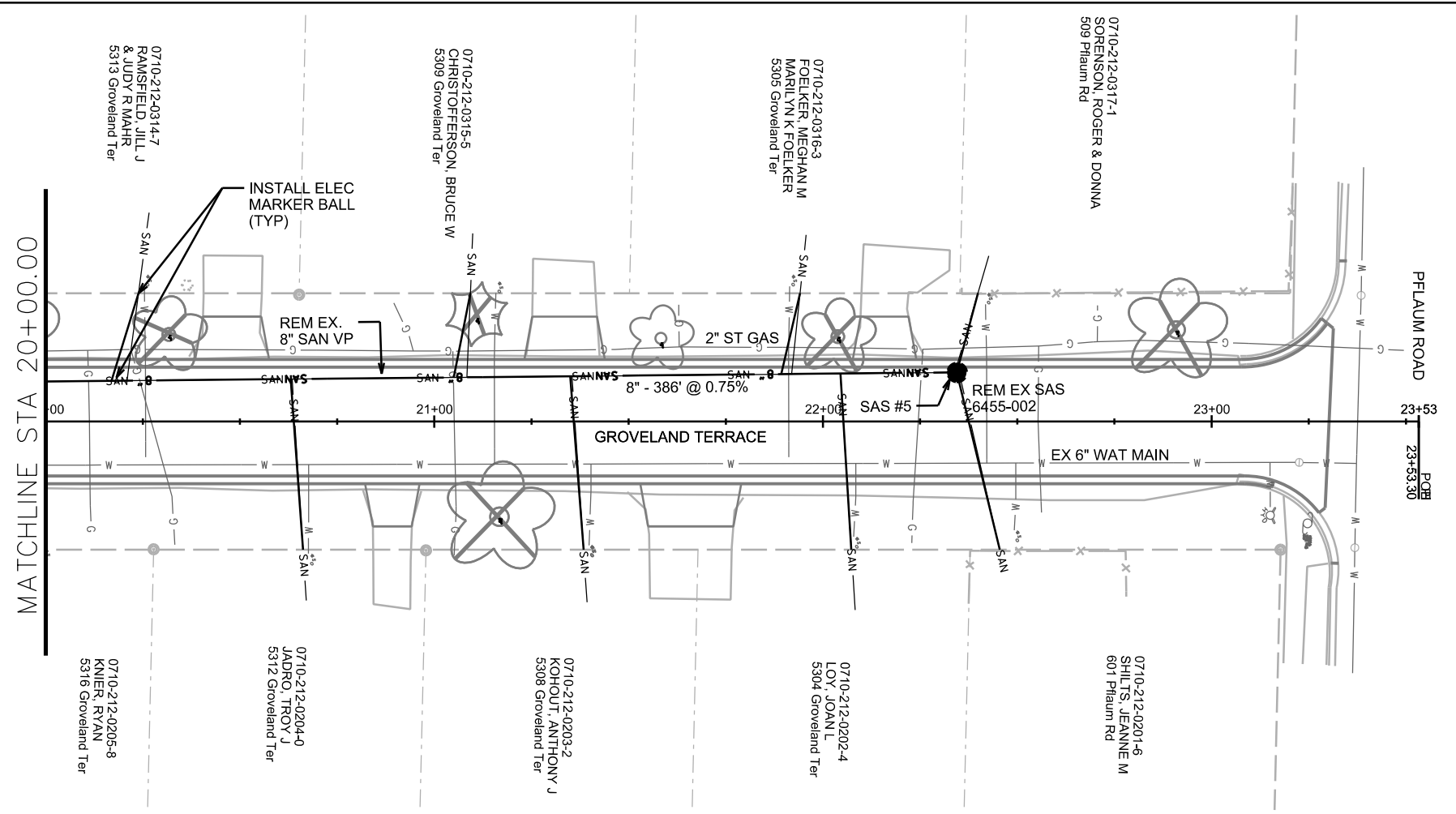
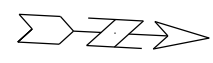

PLOT SCALE: _____

PLOT NAME: _____

REV. DATE: _____

ORIGINATOR: CITY OF MADISON, STREETS DIVISION

SANITARY SEWER SCHEDULE

GROVELAND TERRACE 2019

PROJECT NO. 11872

SHEET NO.

U-4

SANITARY SEWER SCHEDULE

CITY OF MADISON

ALL STATION OFFSETS FROM GROVELAND TER ALIGNMENT

PROPOSED SANITARY STRUCTURES

SAS NO.	STATION	LOCATION (OFFSET)	TOP OF CASTING	E.I.	DEPTH	NOTES
ACACIA LN						
SAS #1	13+30.88	LT-54.94	903.85	896.83	7.02	(1)
GROVELAND TER						
SAS #2	13+29.80	LT-12.95	903.87	896.94	6.93	(2)
SAS #3	15+84.94	LT-10.18	906.76	897.85	8.91	
SAS #4	18+48.30	LT-8.78	908.04	898.44	9.60	
SAS #5	22+34.42	LT-12.66	912.41	901.39	11.02	(3)
DOUGLAS TRL						
SAS #4A	18+49.54	LT-56.77	908.27	898.83	9.44	(4)

SANITARY STRUCTURE REMOVALS

STRUCTURE ID NO.	STATION	LOCATION (OFFSET)	TOP OF CASTING	E.I.	DEPTH	NOTES
GROVELAND TER						
EX SAS 6456-020	10+77.46	LT-10.22	905.76	897.98	7.78	
EX SAS 6456-002	22+34.53	LT-12.61	912.74	903.10	9.64	
EX SAS 6455-005	15+85.03	LT-10.16	906.23	897.85	8.38	
EX SAS 6455-003	18+48.40	LT-8.76	908.02	898.44	9.58	
EX SAS 6455-002	13+29.87	LT-12.94	904.22	896.94	7.28	

PROPOSED SANITARY PIPES

FROM (DNSTM)	TO (UPSTM)	DWNSTRM E.I.	UPSTRM E.I.	PLAN (PAY) LGTH (FT)	SLOPE (%)	PIPE SIZE	PVC TYPE	NOTES
ACACIA LN								
SAS #1	SAS #2	896.87	896.94	42	0.17%	10"	SDR-35	
GROVELAND TER								
SAS #2	EX SAS 6456-020	896.99	898.06	252	0.42%	8"	SDR-35	(5)
SAS #2	SAS #3	896.96	897.85	255	0.35%	10"	SDR-35	
SAS #3	SAS #4	897.90	898.44	263	0.21%	10"	SDR-35	
SAS #4	SAS #5	898.49	901.39	386	0.75%	8"	SDR-35	
DOUGLAS TRL								
SAS #4	SASA #4A	898.50	898.83	48	0.69%	8"	SDR-35	

SANITARY PIPE REMOVALS

REMOVE FROM	REMOVE TO	LGTH (FT)	PIPE TYPE	PIPE SIZE	PAID (Y/N)	NOTES
GROVELAND TER						
EX SAS 6456-002	EX SAS 6456-020	252	VP	8'	N	
EX SAS 6456-002	EX SAS 6455-005	255	VP	10"	N	
EX SAS 6455-005	EX SAS 6455-003	263	VP	10"	N	
EX SAS 6455-003	EX SAS 6455-002	386	VP	8"	N	

SPECIFIC NOTES

- (1) CONNECT TO EX 10" SAN VP
- (2) INSTALL INTERNAL CHIMNEY SEAL
- (3) TWO LATERAL TAPS; SEE SHEET U-3
- (4) CONNECT TO EX 8" SAN VP; FIELD TAP
- (5) CONNECT PROP 8" PVC TO EXISTING 8" PVC AFTER REMOVING EX SAS 6456-020

STORM SEWER SCHEDULE

GROVELAND TERRACE 2019

PROJECT NO. 11872

SHEET NO.

U-5

STORM SEWER SCHEDULE

CITY OF MADISON

PROPOSED STORM STRUCTURES

STRUC. NO.	STATION	LOCATION (OFFSET)	TYPE	TOP OF CASTING	E.I.	DEPTH	NOTES
GROVELAND							
T-1	13+55.04	RT-20.17	TAP	-	900.20	-	EX AS 6456-027
S-1	13+75.03	RT-15.63	H Inlet	904.53	900.42	4.11	W/3067-7004-V
S-2	13+75.66	LT-15.52	H Inlet	904.47	900.64	3.83	LP; W/3067-7004-VB
S-3	13+56.16	LT-38.59	3X3 SAS	904.12	901.03	3.09	LP;FP; W/3067-7004-VB
S-3A	13+56.36	LT-46.59	PIPE PLUG	-	901.11	-	
S-4	13+25.20	LT-38.42	H Inlet	903.98	901.22	2.76	LP;FP; W/3067-7004-VB
S-5	13+04.70	LT-15.50	H Inlet	904.61	901.61	3.00	FP; W/3067-7004-V
S-6	13+04.00	RT-15.91	H Inlet	904.67	901.81	2.86	FP; W/3067-7004-V
T-2	18+41.35	RT-38.65	TAP	-	903.84	-	EX IN 6455-025
S-7	18+22.84	RT 15.57	H Inlet	908.07	903.97	4.10	LP; W/3067-7004-VB
S-8	18+23.51	LT-15.50	H Inlet	908.07	904.13	3.94	LP; W/3067-7004-VB
S-9	18+44.03	LT-38.41	3X3 SAS	908.14	903.98	4.16	LP; W/3067-7004-VB
S-9A	18+44.22	LT-46.41	PIPE PLUG	-	904.53	-	
S-10	18+75.05	LT-38.59	H Inlet	908.54	904.53	4.01	LP; W/3067-7004-VB
T-3	18+93.70	RT-15.56	TAP	-	905.28	-	EX IN 6455-027
S-11	18+94.49	LT-15.52	H Inlet	908.53	905.43	3.10	LP;FP; W/3067-7004-VB

PROPOSED STORM PIPES

PIPE NO.	FROM (DNSTM)	TO (UPSTM)	DISCH. E.I.	INLET E.I.	PLAN (PAY) LGTH (FT)	PIPE LGTH (FT)	SLOPE (%)	PIPE SIZE	TYPE	NOTES
GROVELAND TER										
P-1	T-1	S-1	900.20	900.42	21	17	1.26%	18"	RCP	TAP EX SAS
P-2	S-1	S-2	900.52	900.64	31	29	0.41%	18"	RCP	
P-3	S-2	S-3	900.89	901.03	30	27	0.51%	15"	RCP	
P-3B	S-3	S-3A	901.08	901.11	8	6.5	0.46%	15"	RCP	
P-4	S-3	S-4	901.08	901.22	31	29	0.48%	15"	RCP	
P-5	S-4	S-5	901.47	901.61	31	28	0.50%	12"	RCP	
P-6	S-5	S-6	901.66	901.81	31	29	0.51%	12"	RCP	
P-7	T-2	S-9	903.84	903.98	29	27	0.52%	15"	RCP	TAP EX INLET
P-8	S-7	S-8	903.98	904.13	30	29	0.52%	15"	RCP	
P-9	S-8	S-9	904.13	904.27	31	27	0.52%	15"	RCP	
P-9A	S-9	S-9A	904.46	904.49	8	6	0.50%	15"	RCP	
P-10	S-9	S-10	904.39	904.53	31	29	0.48%	12"	RCP	
P-11	T-3	S-11	905.28	905.43	32	30	0.50%	12"	RCP	TAP EX INLET

UTILITY LINE OPENINGS

ULO NO.	STATION	LOCATION (OFFSET)	TYPE	NOTE
GROVELAND				
ULO-1	STA 13+09.41	LT 20.77'	GAS	MG&E MAY RELOCATE MAIN
ULO-2	STA 13+23.42	LT 37.42'	GAS	MG&E MAY RELOCATE MAIN
ULO-3	STA 13+39.55	LT 38.50'	GAS	MG&E MAY RELOCATE MAIN
ULO-4	STA 18+27.47	LT 19.92'	GAS	MG&E MAY RELOCATE MAIN

NOTE: PLAN LENGTH (PAY LENGTH) IS FROM CENTER OF STRUCTURE TO CENTER OF STRUCTURE. PIPE LENGTH IS ACTUAL LENGTH OF PIPE FROM STRUCTURE WALL TO STRUCTURE WALL. SLOPE CALCULATED USING PIPE LENGTH.

STANDARD NOTES:

- ABBREVIATIONS: AE = APRON ENDWALL; RCP = REINFORCED CONCRETE PIPE; HERCP = HORIZONTAL ELLIPTICAL REINFORCED CONCRETE PIPE; DNA = DOES NOT APPLY; SAS = SEWER ACCESS STRUCTURE; LP = LOW POINT INLET STRUCTURE; FP = FIELD POURED STRUCTURE; TR = TOP OF CONCRETE ROOF; NCM = NO CROWN MATCH FOR PIPES; UD = UNDERDRAIN
- APPROXIMATE DISCHARGE E.I. GIVEN, ADJUST E.I. AND PIPE SLOPE IN THE FIELD.
- TOP OF CASTING GRADE GIVEN IS THE TOP OF CURB FOR INLET STRUCTURES AND THE FLOWLINE OF THE CLOSED CASTING FOR SAS's.
- TOP OF CONCRETE ROOF (TR) IS 1.25' BELOW TOP OF CASTING UNLESS OTHERWISE NOTED.
- ALL REINFORCED CONCRETE PIPES TO BE CLASS III UNLESS OTHERWISE NOTED.
- SURVEYOR TO CONFIRM THAT ALL INLET STATION / OFFSETS LINE UP WITH PROPOSED CURB AND GUTTER.
- ALL STRUCTURES CALLED OUT AS FIELD POURED SHALL BE FIELD POURED. ALL OTHER STRUCTURES (NOT INDICATED AS FIELD POURED) SHALL BE SUBMITTED TO CITY ENGINEERING FOR APPROVAL IF PRECAST STRUCTURES ARE PREFERRED. CONTACT LUCAS WARDELL OF CITY ENGINEERING AT (608) 243-5894 FOR PRECAST APPROVALS, FAX SHOP DRAWINGS TO (608)264-9275, OR EMAIL SHOP DRAWINGS TO LWARDELL@CITYOFMADISON.COM.

SPECIFIC NOTES

CROSS SECTIONS

GROVELAND TERRACE

CITY OF MADISON

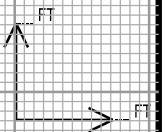
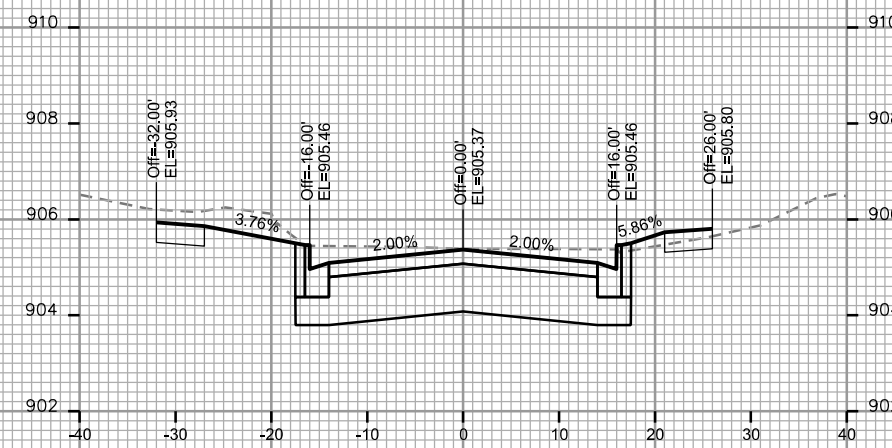
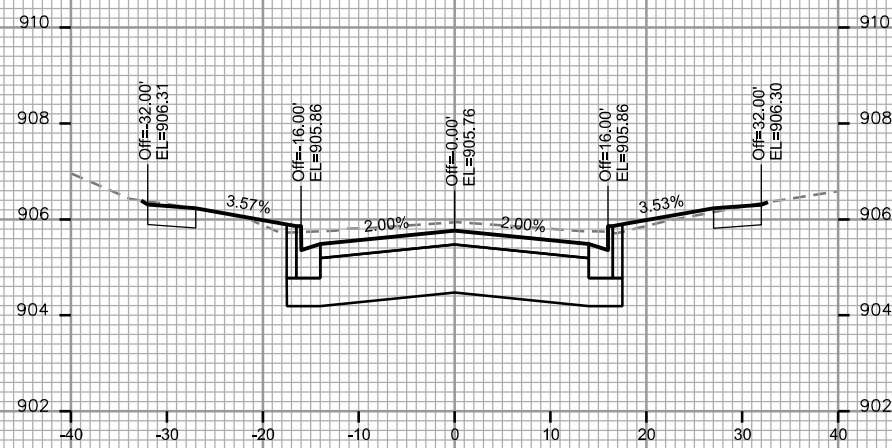
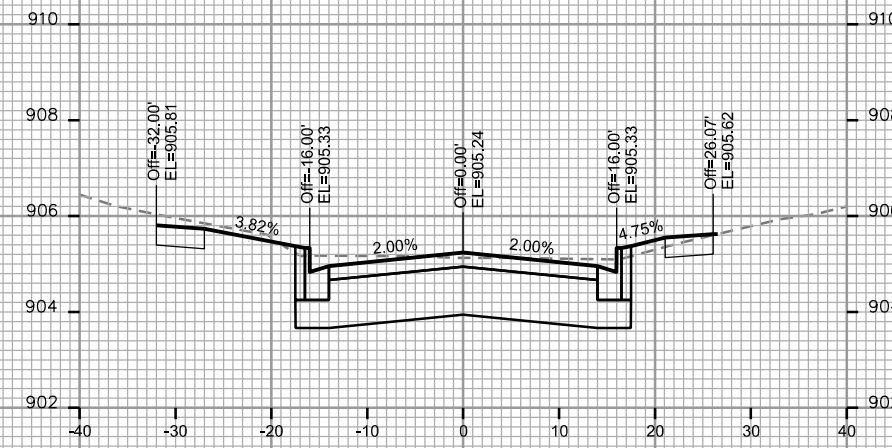
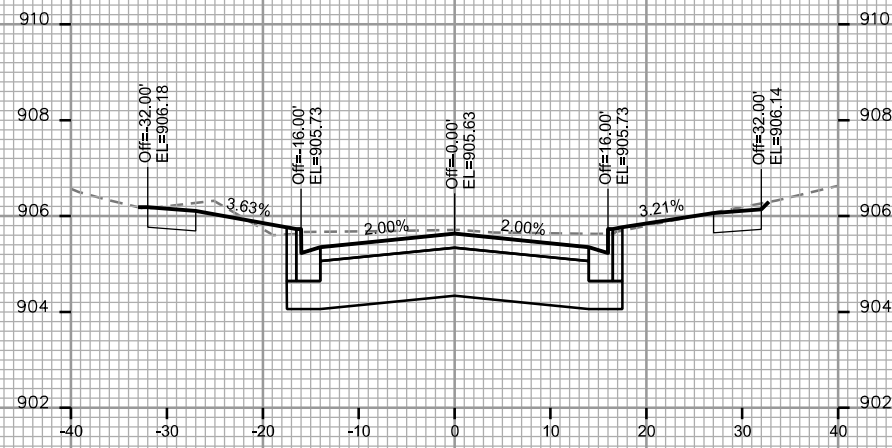
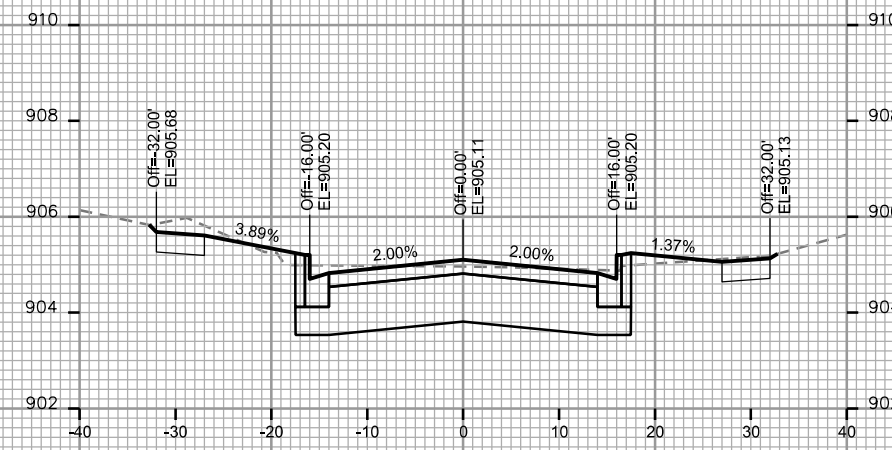
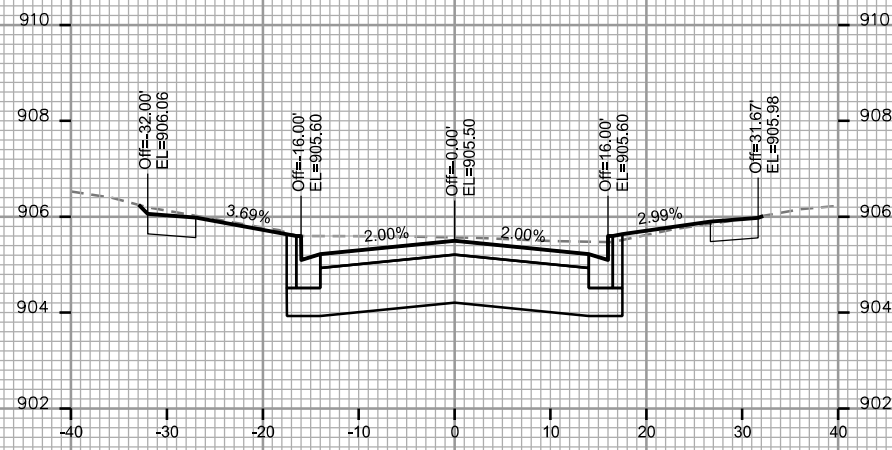

PLOT SCALE: _____

PLOT NAME: _____

REV. DATE: _____

ORIGINATOR: CITY OF MADISON - STREETS DIVISION

CROSS SECTIONS

GROVELAND TERRACE

CITY OF MADISON

PLOT SCALE: _____

PLOT NAME: _____

REV. DATE: _____

ORIGINATOR: CITY OF MADISON, STREETS DIVISION

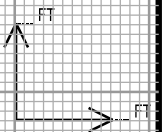
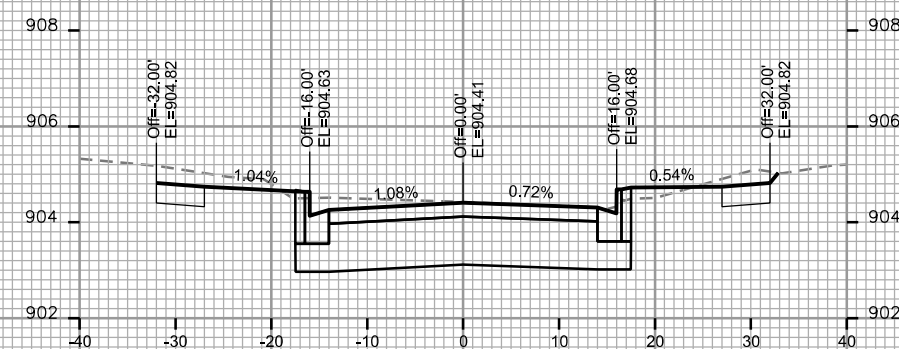
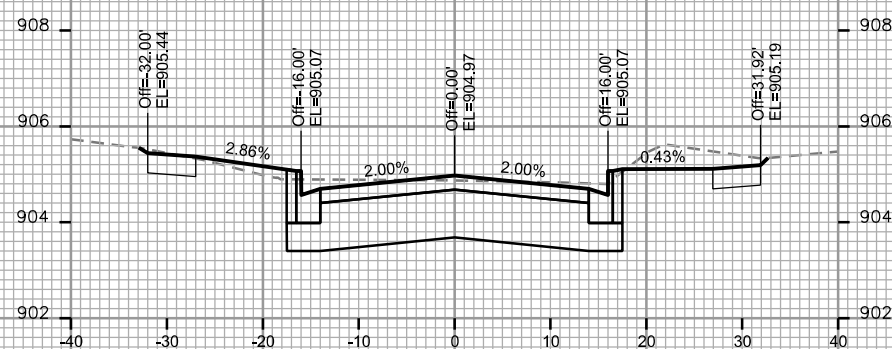
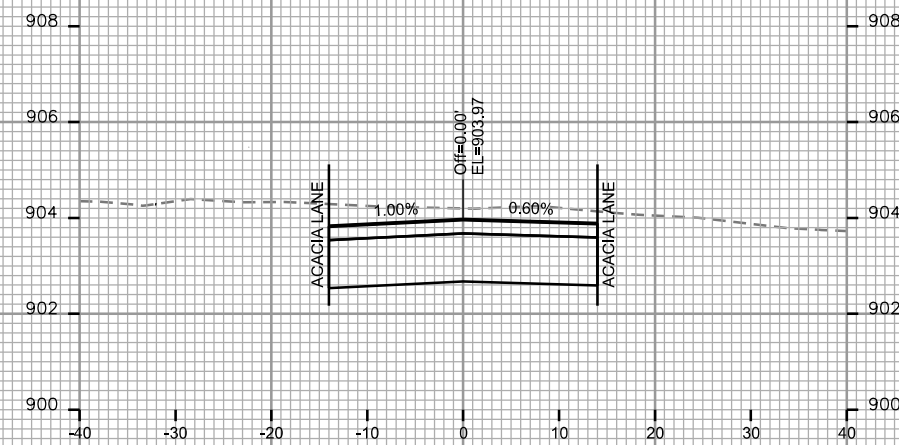
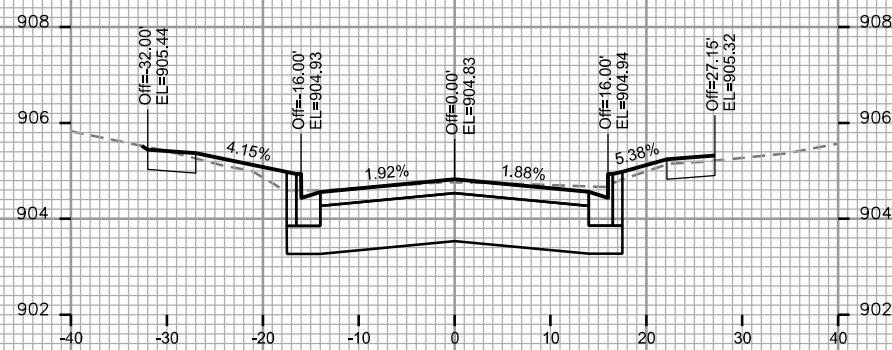
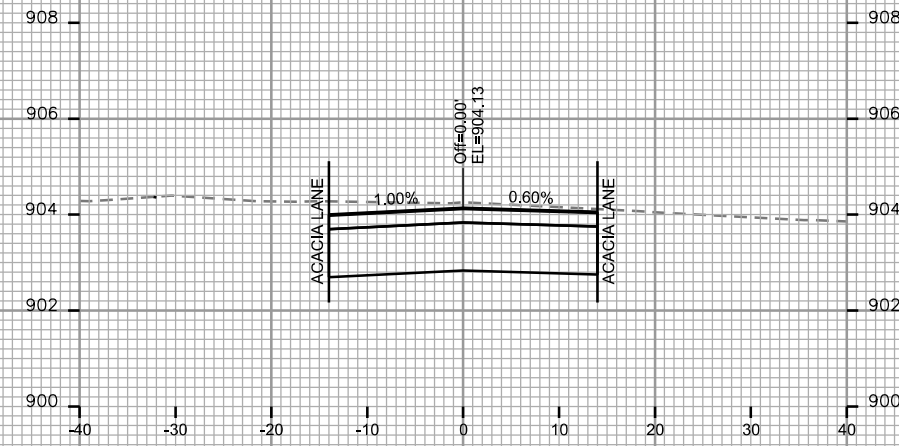
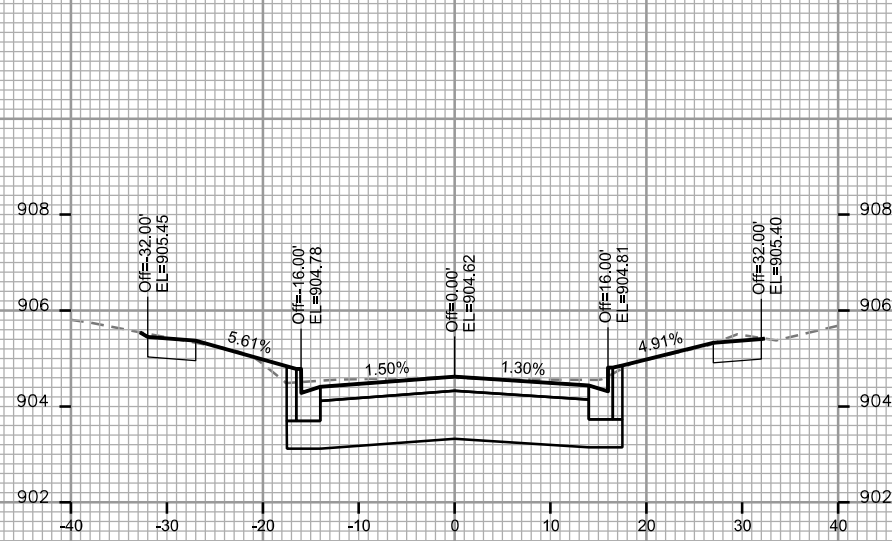

CROSS SECTIONS

GROVELAND TERRACE

CITY OF MADISON

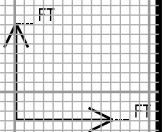
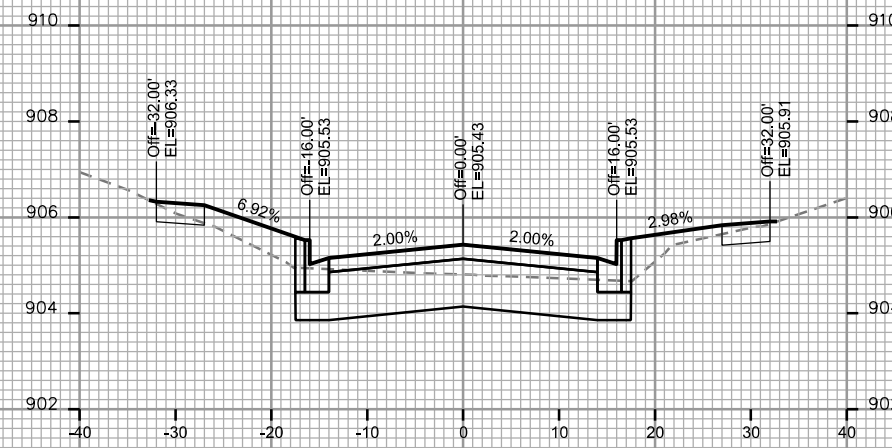
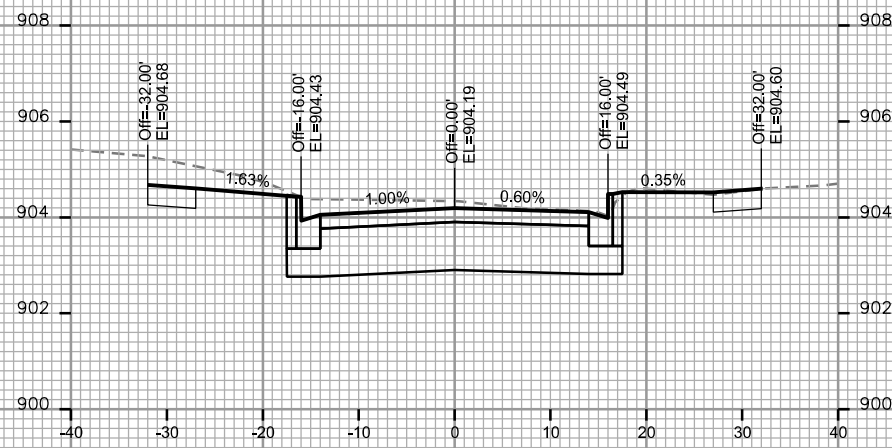
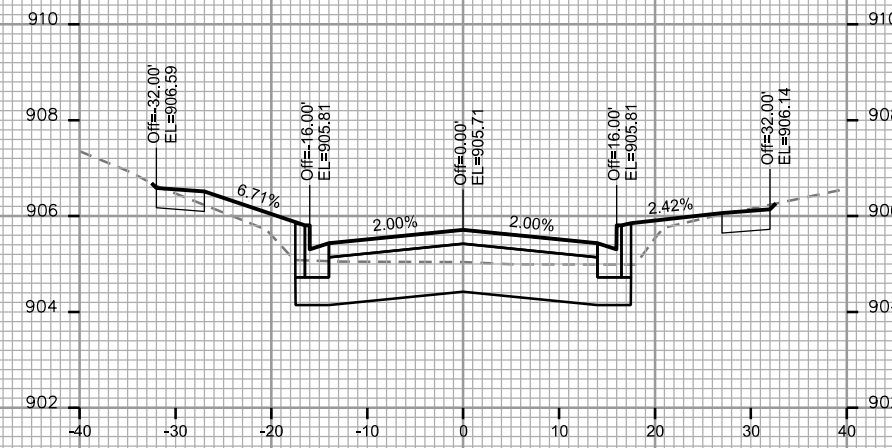
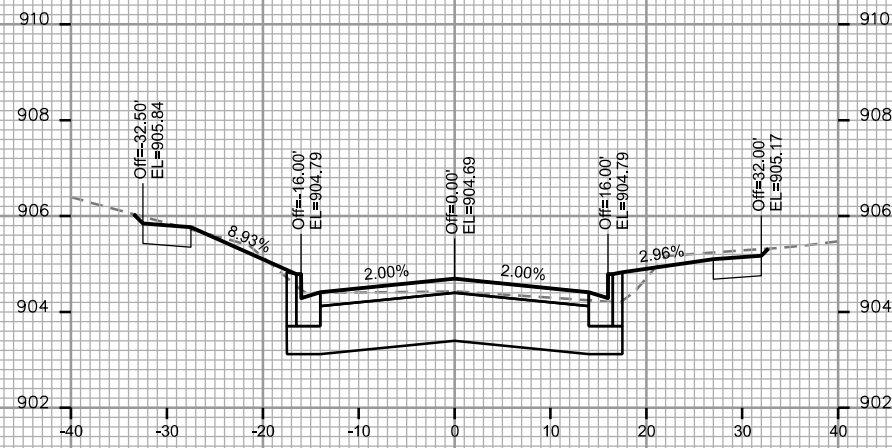
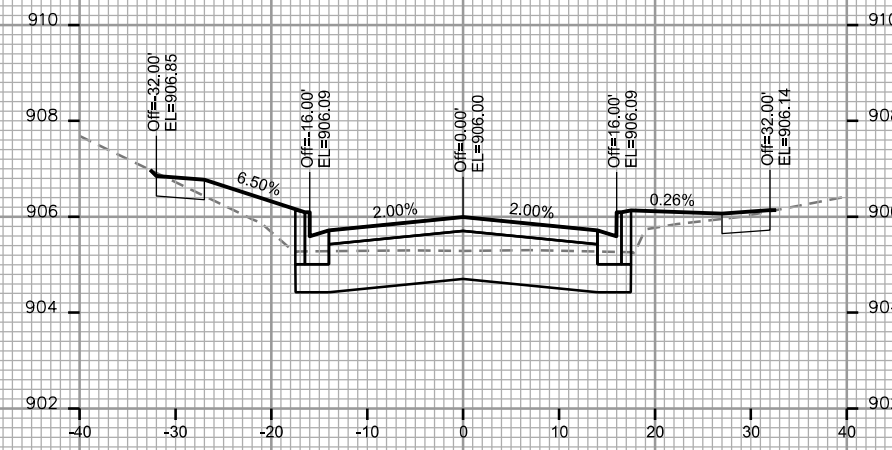
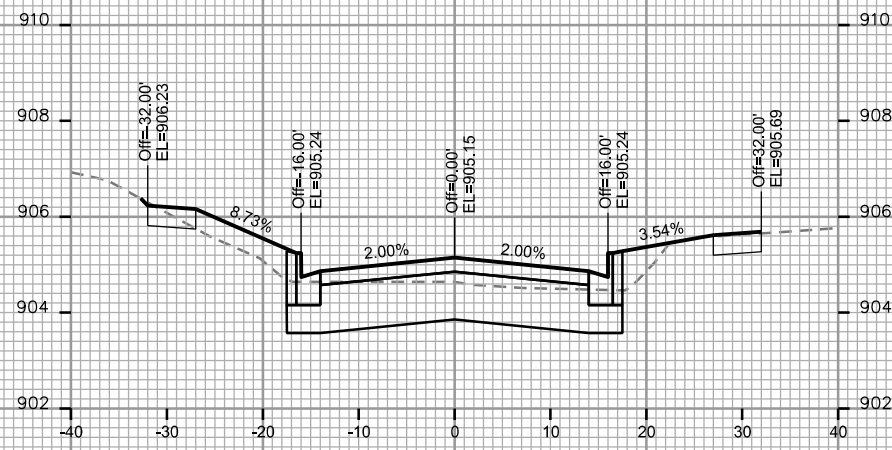

PLOT SCALE: _____

PLOT NAME: _____

REV. DATE: _____

ORIGINATOR: CITY OF MADISON - STREETS DIVISION

CROSS SECTIONS
GROVELAND TERRACE CITY OF MADISON

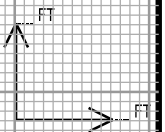
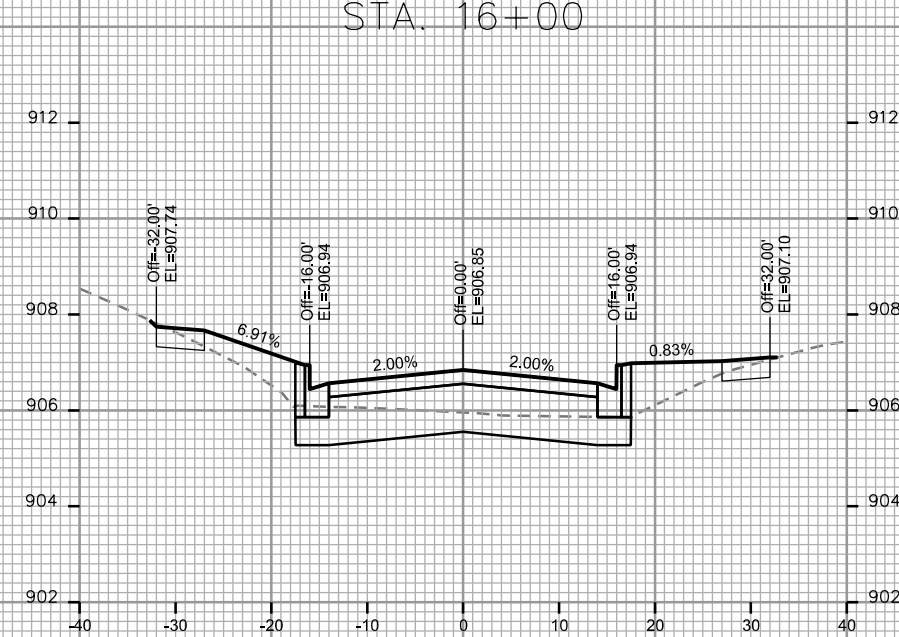
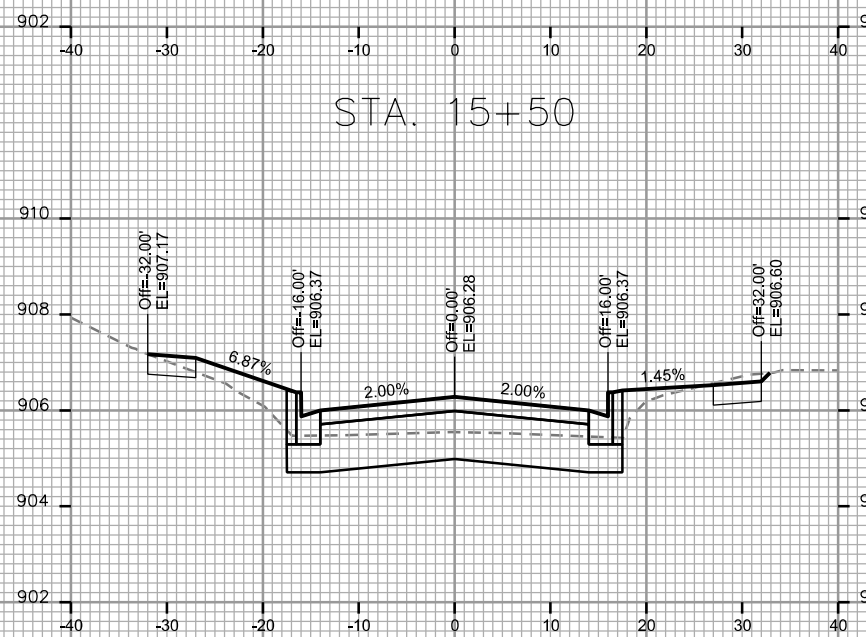
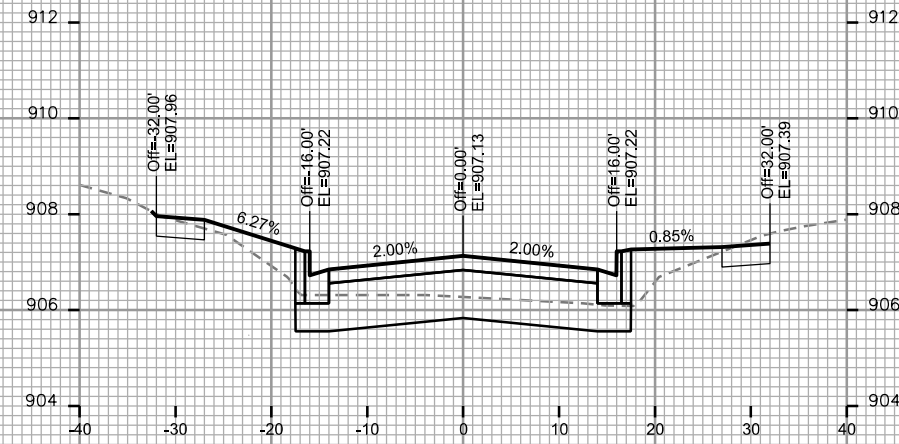
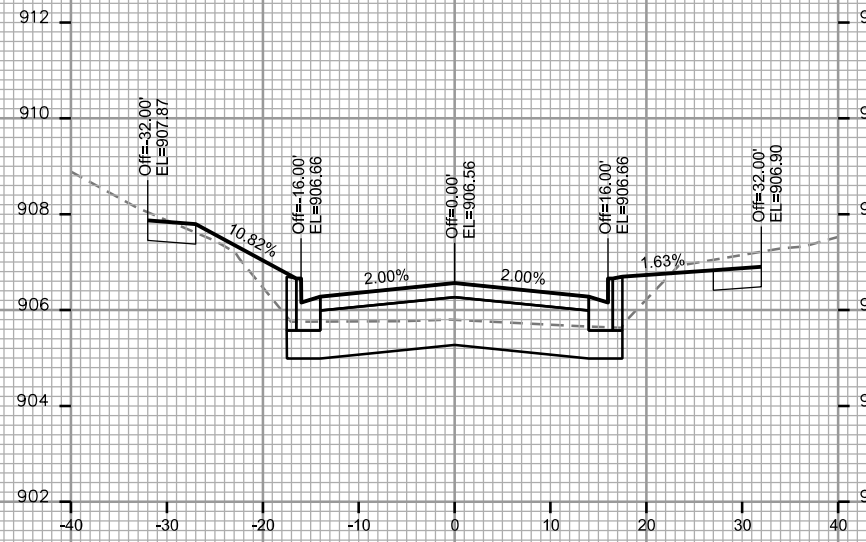
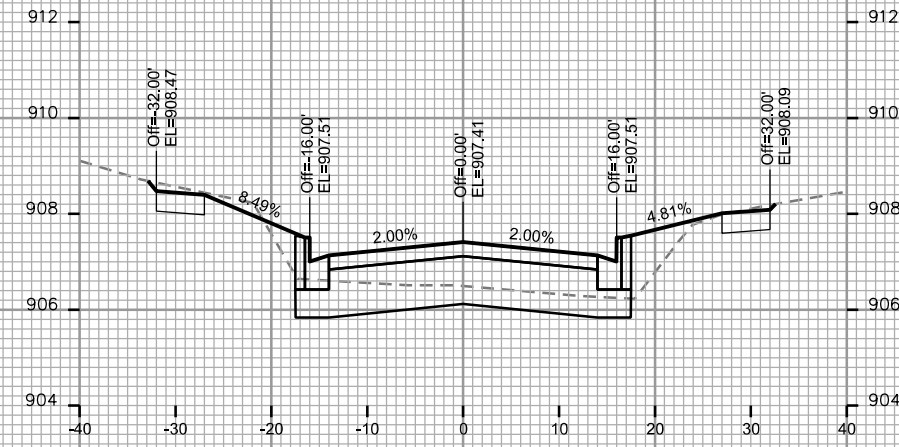

PLOT SCALE: _____

PLOT NAME: _____

REV. DATE: _____

ORIGINATOR: CITY OF MADISON - STREETS DIVISION

CROSS SECTIONS

GROVELAND TERRACE

CITY OF MADISON

PLOT SCALE: _____

PLOT NAME: _____

REV. DATE: _____

ORIGINATOR: CITY OF MADISON - STREETS DIVISION

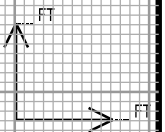
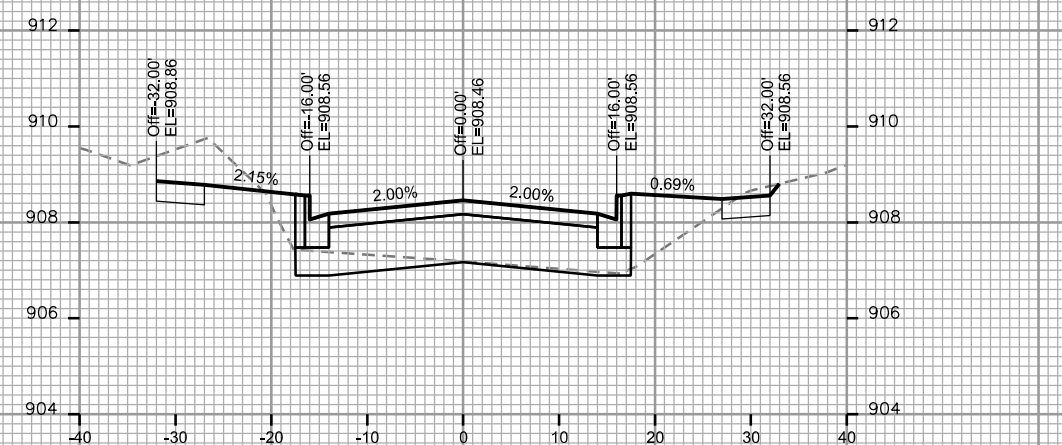
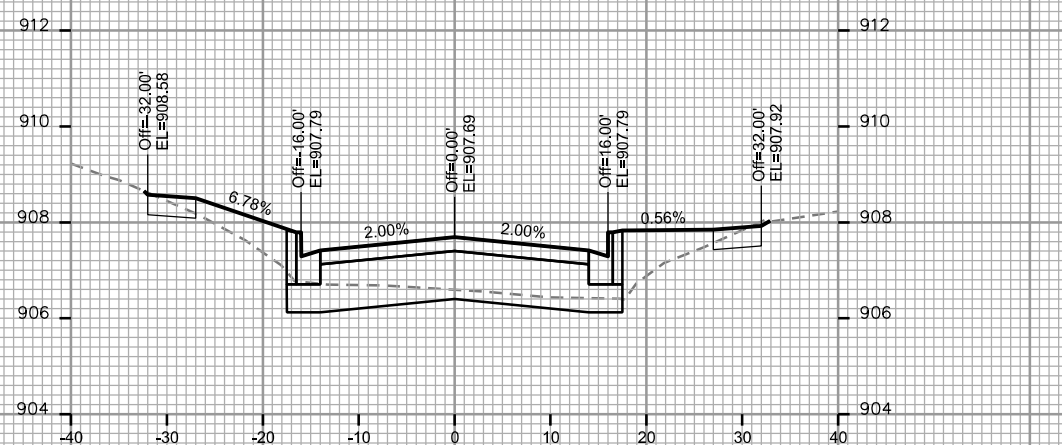
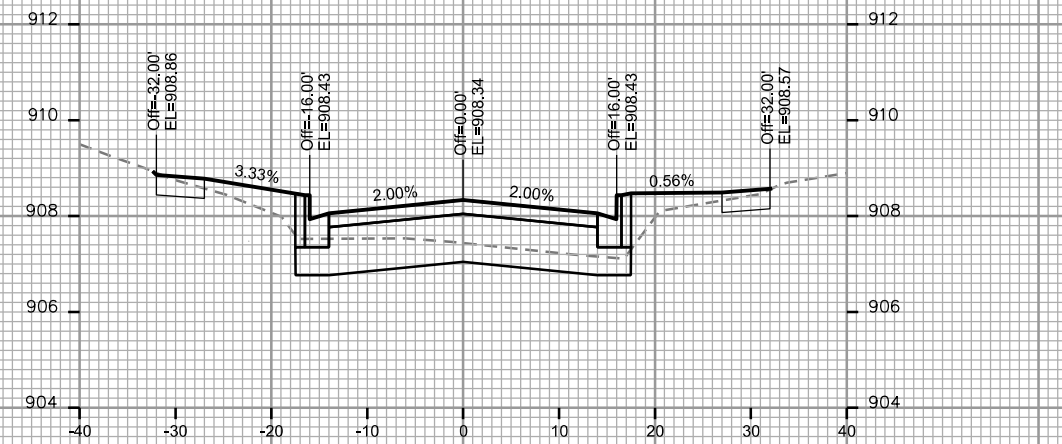
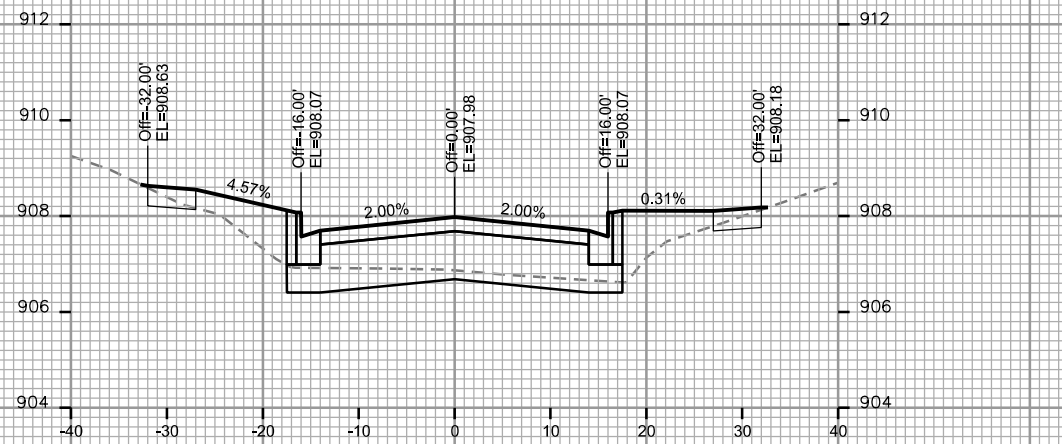
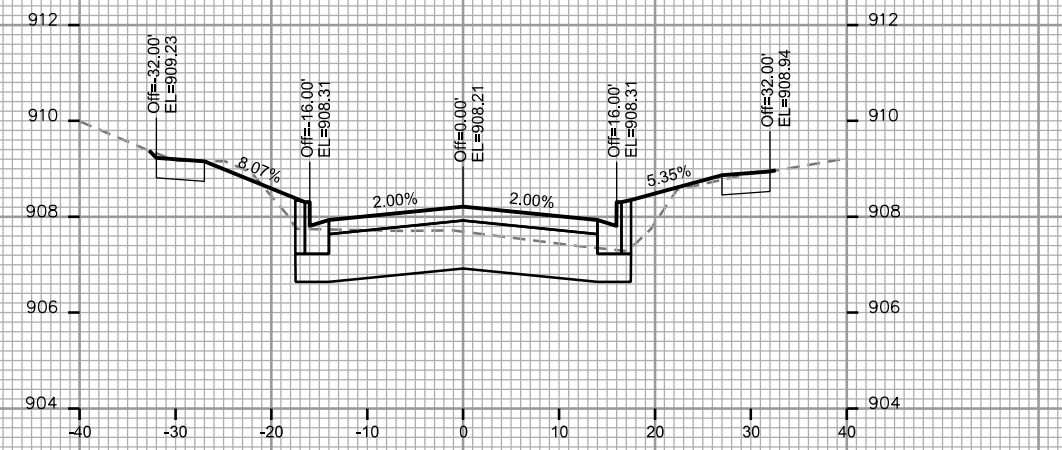
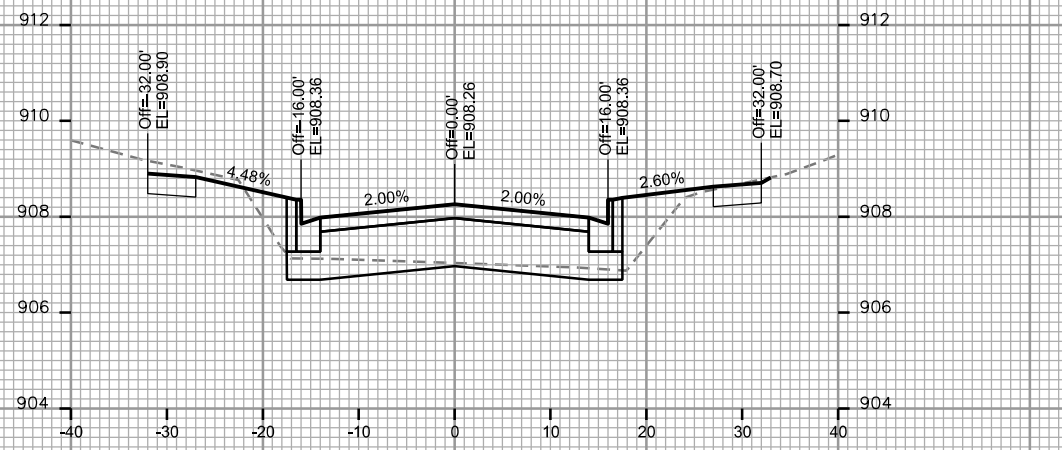

CROSS SECTIONS

GROVELAND TERRACE

CITY OF MADISON

PLOT SCALE: _____

PLOT NAME: _____

REV. DATE: _____

ORIGINATOR: CITY OF MADISON, STREETS DIVISION

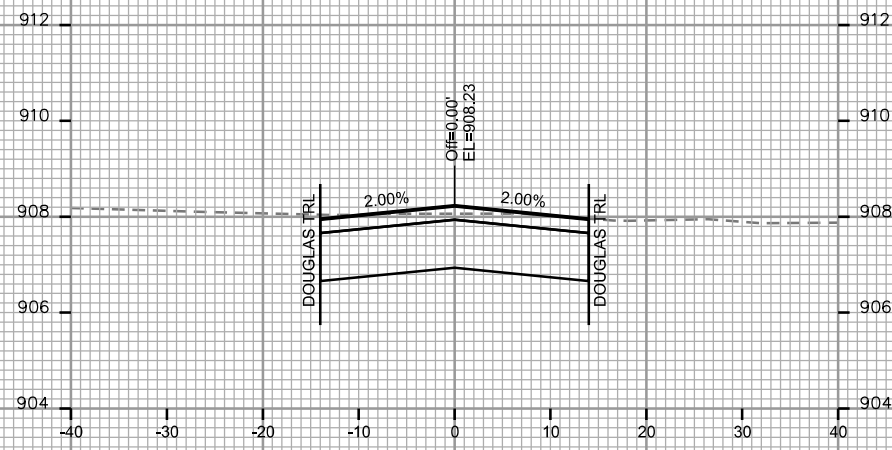

STA. 18+50

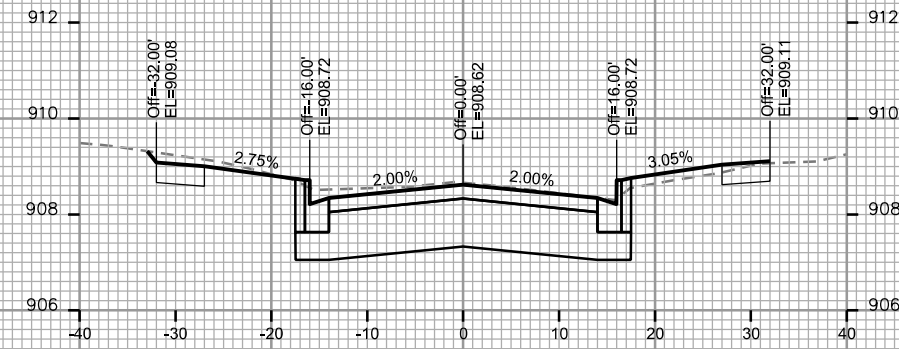

STA. 19+25

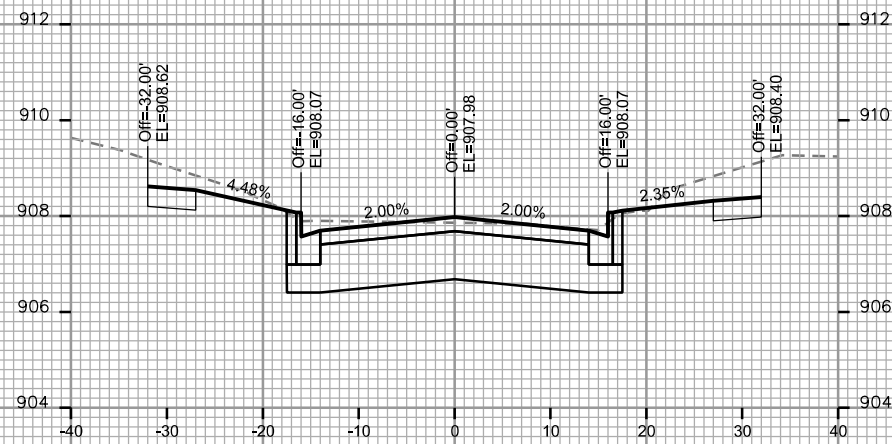

STA. 18+25

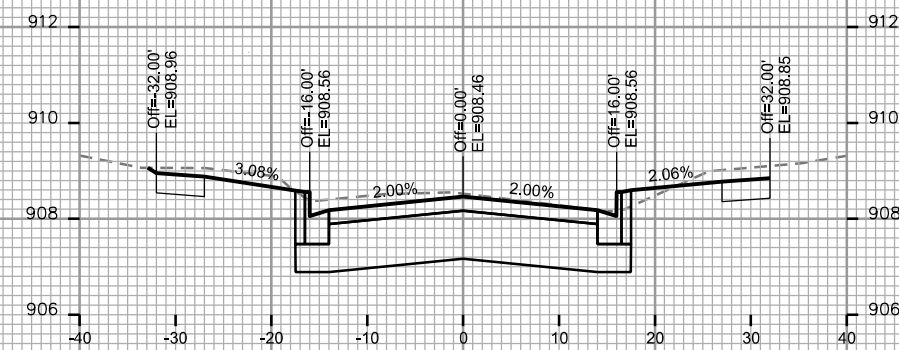

STA. 19+00

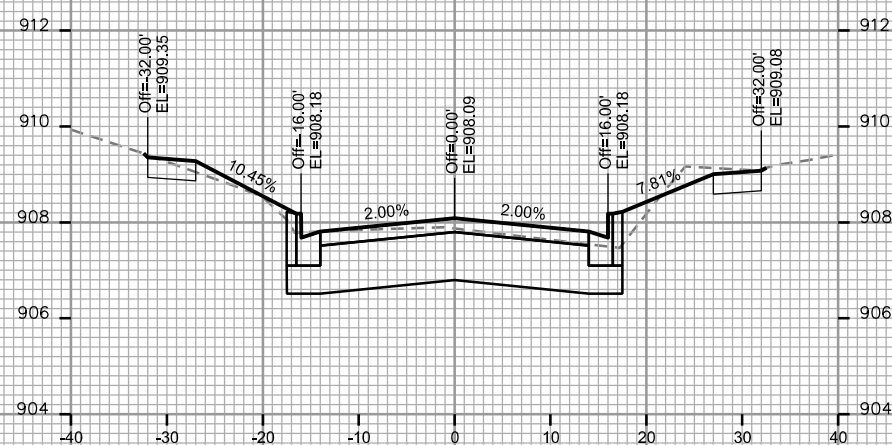

STA. 18+00

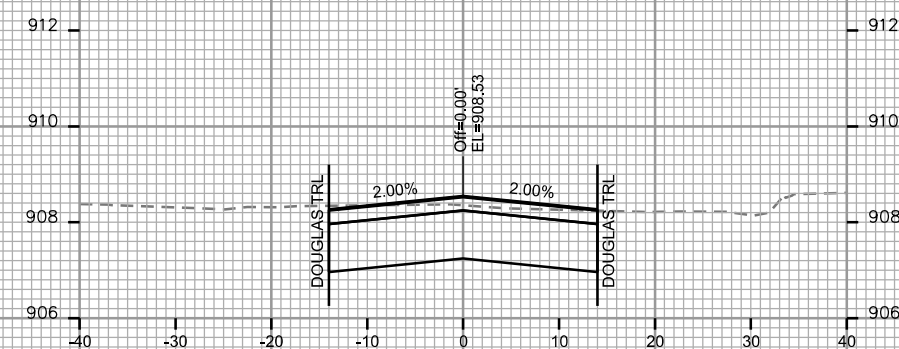

STA. 18+75

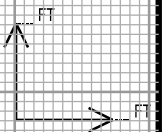

CROSS SECTIONS

GROVELAND TERRACE

CITY OF MADISON

PLOT SCALE: _____

PLOT NAME: _____

REV. DATE: _____

ORIGINATOR: CITY OF MADISON, STREETS DIVISION

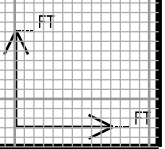
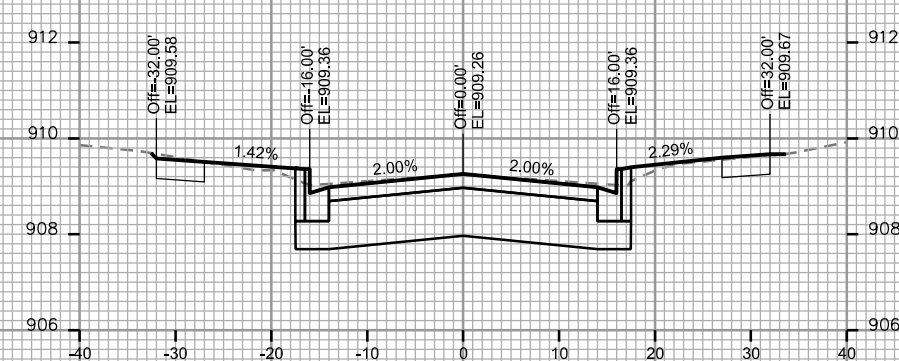
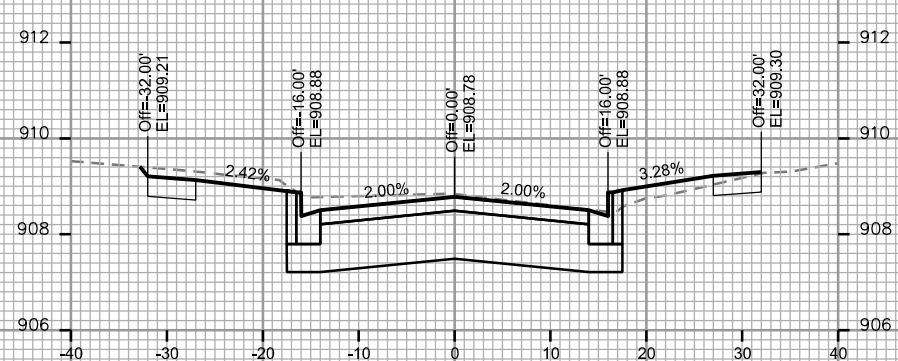
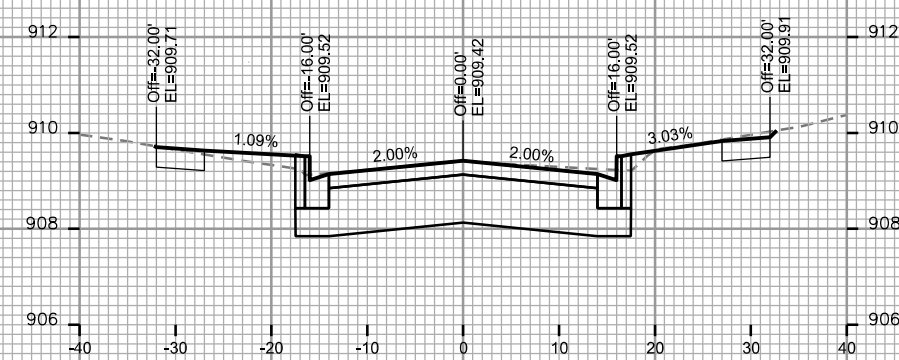
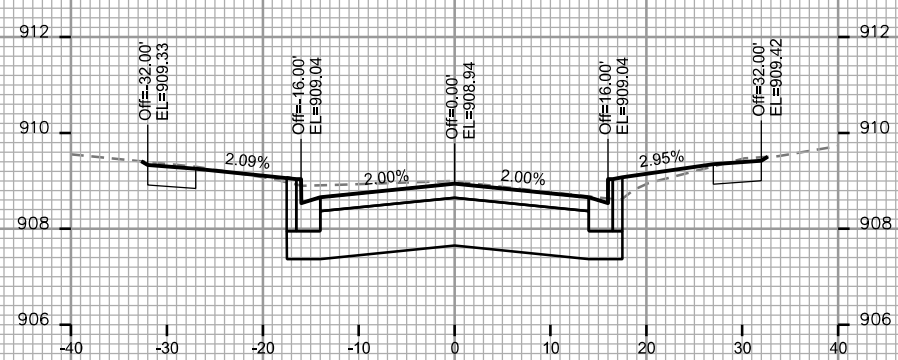
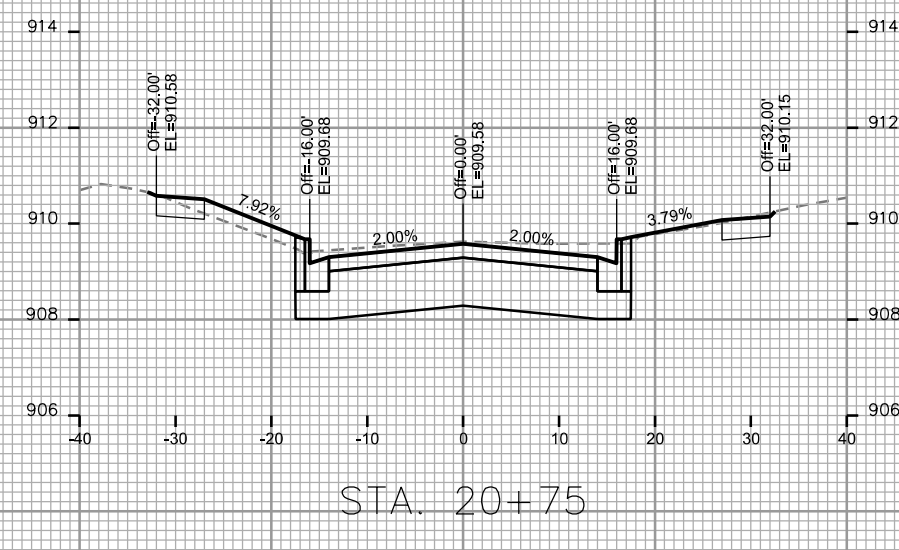
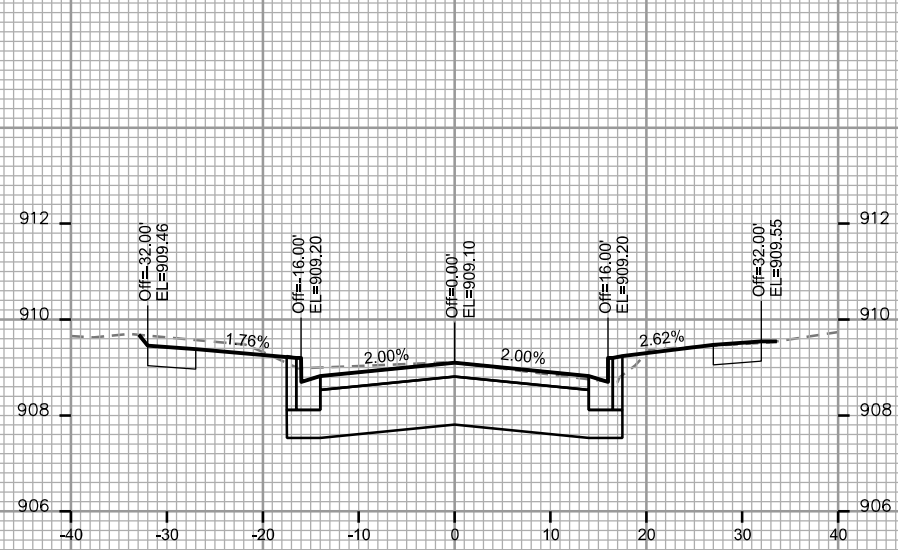

CROSS SECTIONS

GROVELAND TERRACE

CITY OF MADISON

PLOT SCALE: _____

PLOT NAME: _____

REV. DATE: _____

ORIGINATOR: CITY OF MADISON, STREETS DIVISION

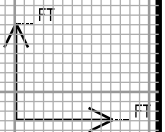
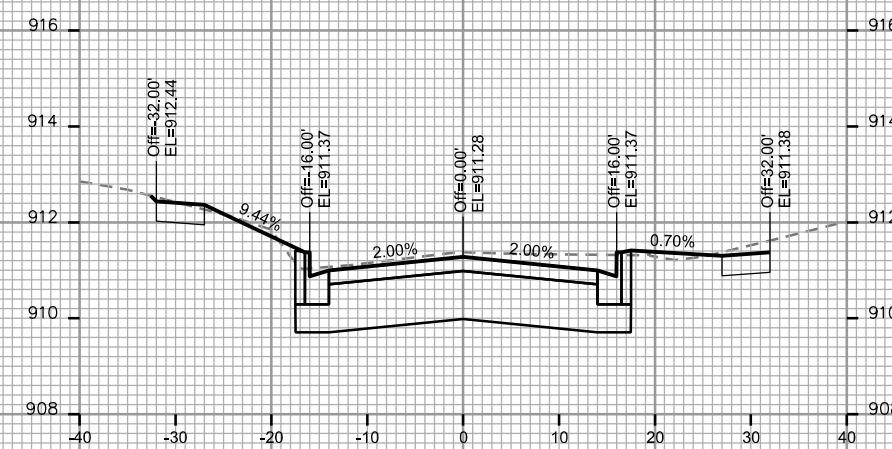
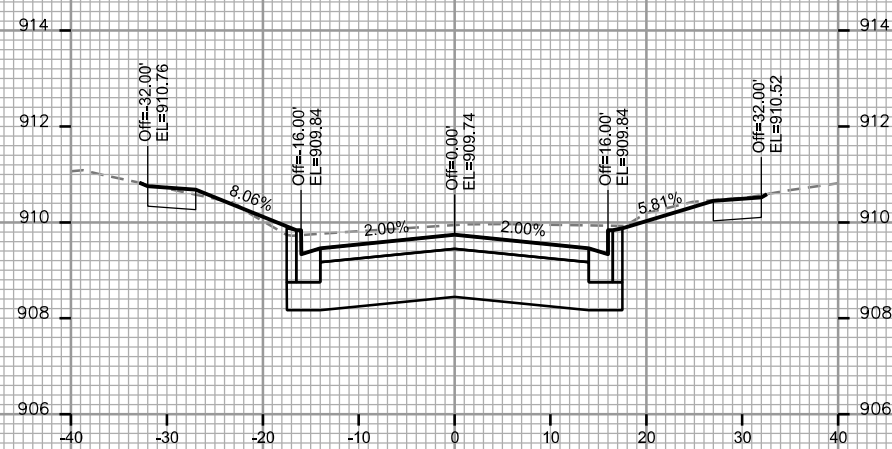
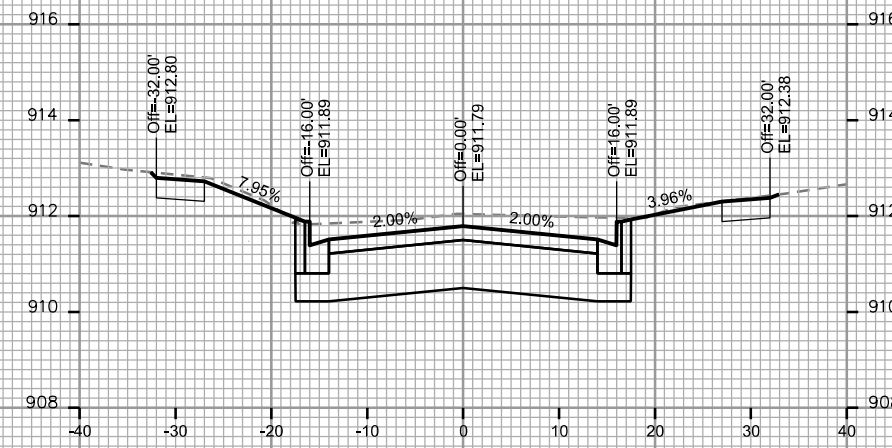
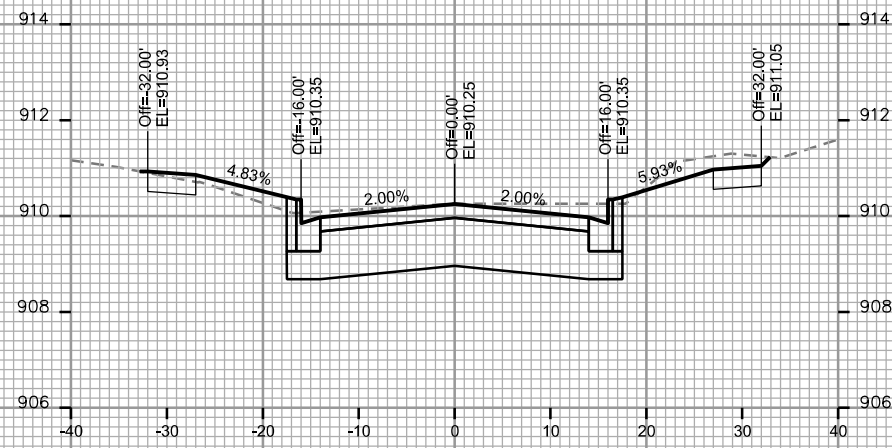
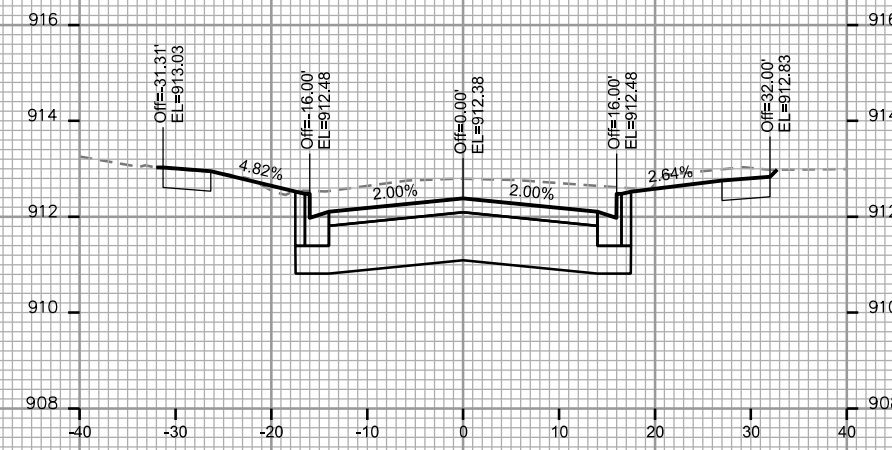
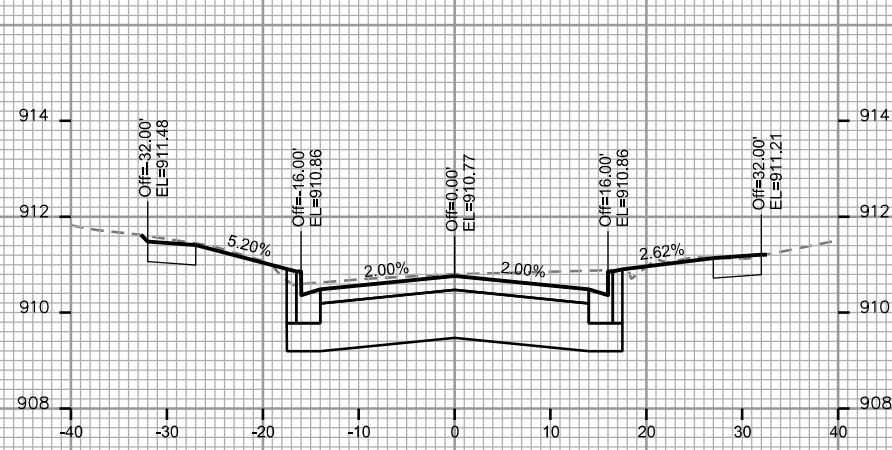

CROSS SECTIONS

GROVELAND TERRACE

CITY OF MADISON

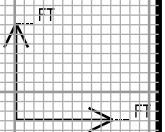
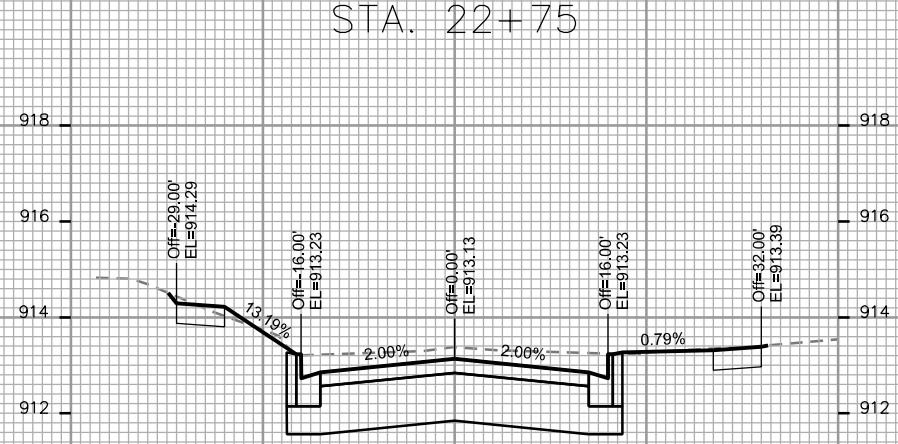
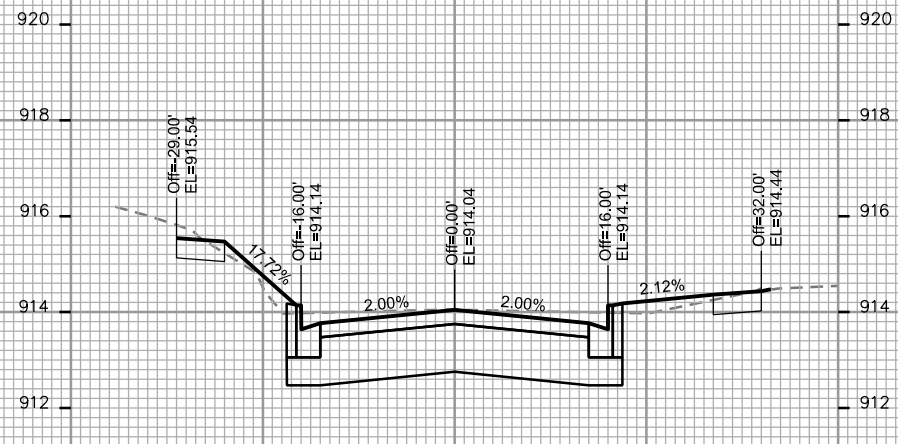
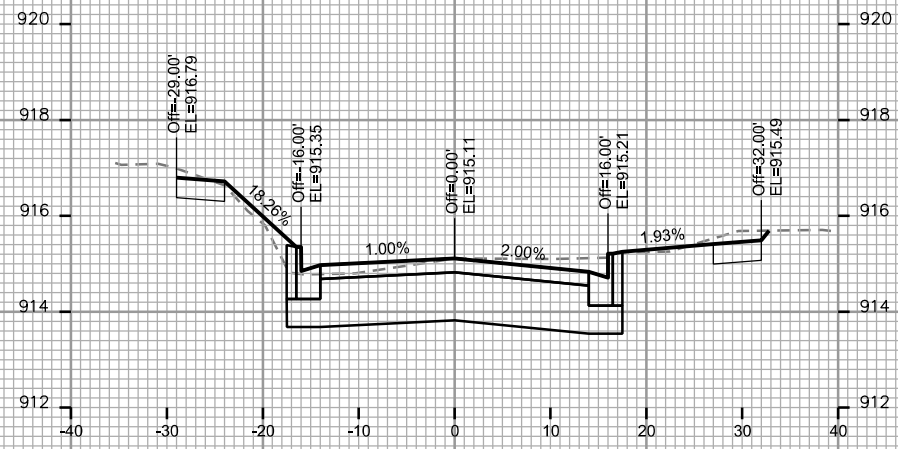

PLOT SCALE: _____

PLOT NAME: _____

REV. DATE: _____

ORIGINATOR: CITY OF MADISON, STREETS DIVISION